

ALERONES LATERALES "DOWNFORCE" PARA - SIDE SPOILER "DOWNFORCE" -
SEITENFLÜGEL "DOWNFORCE"

KAWASAKI ZX-10R '11-

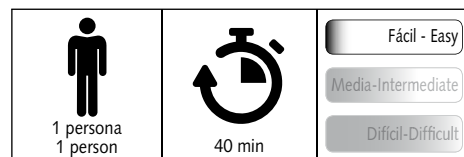

Ref.: 9882

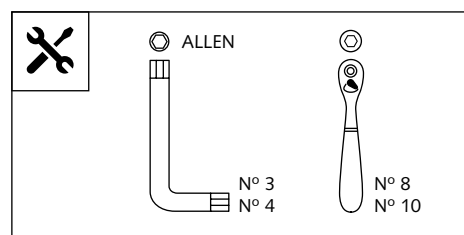

ID	PIEZA / PART	DESCRIPCIÓN	DESCRIPTION	QTY	REF.
1		Base alerón derecha	Right main plain spoiler	1	9882NM3
2		Winglet Negro derecho Winglet Verde derecho	Right Black winglet Right green winglet	2	9882V/NM3
3		Base alerón izquierda	Left main plain spoiler	1	9882NM3
4		Winglet Negro izquierdo Winglet Verde izquierdo	Left Black winglet Left green winglet	2	9882V/NM3
5		Soporte metálico R•	R• metal support	1	SOPOR-4P-6-9882
6		Soporte metálico R••	R•• metal support	1	SOPOR-4P-6-9882
7		Soporte metálico L•	L• metal support	1	SOPOR-4P-6-9882
8		Soporte metálico L••	L•• metal support	1	SOPOR-4P-6-9882
9		Tuerca autoblocante M4	M4 locking nut	4	TUERCAE985-0290
10		Arandela de goma Øint 4,5 Øext 11x2mm	Øinner 4,5 Øouter 11x2mm rubber washer	4	ARAND-EPDM--722
11		Arandela de Nylon M4X0,5	M4X0,5 Nylon washer	8	ARNV00000000311
12		Arandela de Nylon M5X1	M5X1 Nylon washer	4	ARNV00000000245
13		Tuerca grafilada M5	M5 Special nut	2	TUERC-D6923-255
14		Tornillo Allen M5x16 Ø11 ISO 7380	M5x16 Ø11 ISO 7380 Allen screw	2	TORNI-I7380-493
15		Tornillo Allen M5x11 Ø11 ISO 7380	M5x11 Ø11 ISO 7380 Allen screw	4	TORNI-AI----520
16		Tornillo Allen M4x12 Ø9 ISO 7380	M4x12 Ø9 ISO 7380 Allen screw	4	TORNI-I7380-800
17		Tapón tornillo M5 ISO 7380	M5 ISO 7380 Allen screw cap	4	TAPON-----85
18		Espuma adhesiva protectora	Protective adhesive foam	1	ESPUMA-----9882

ALERONES LATERALES "DOWNFORCE" PARA - SIDE SPOILER "DOWNFORCE" - SEITENFLÜGEL "DOWNFORCE" KAWASAKI ZX-10R '11-

INSTRUCCIONES DE MONTAJE - MOUNTING INSTRUCTIONS - MONTAGEANLEITUNG

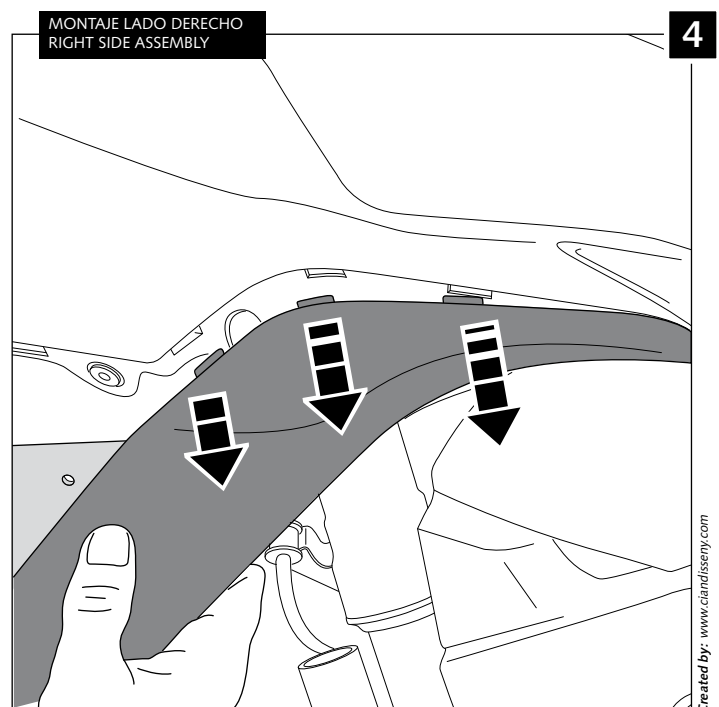
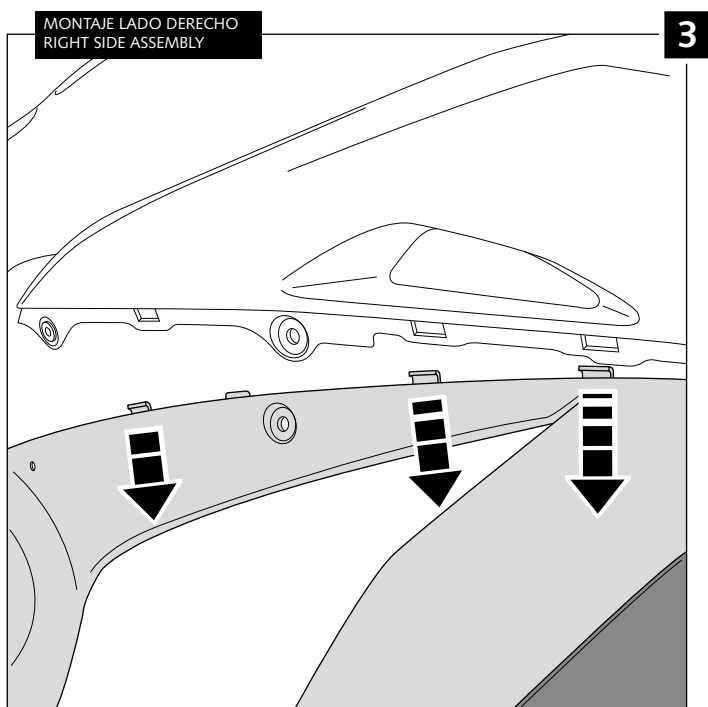
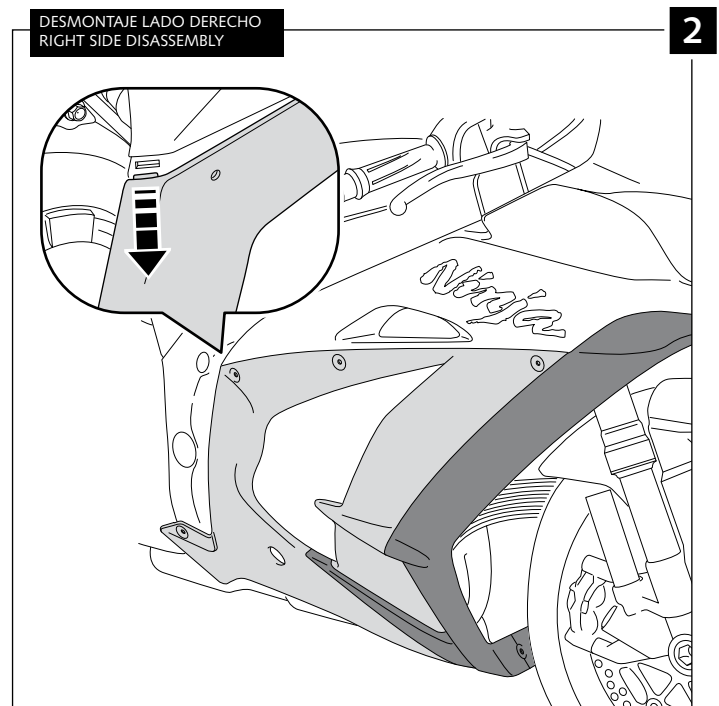
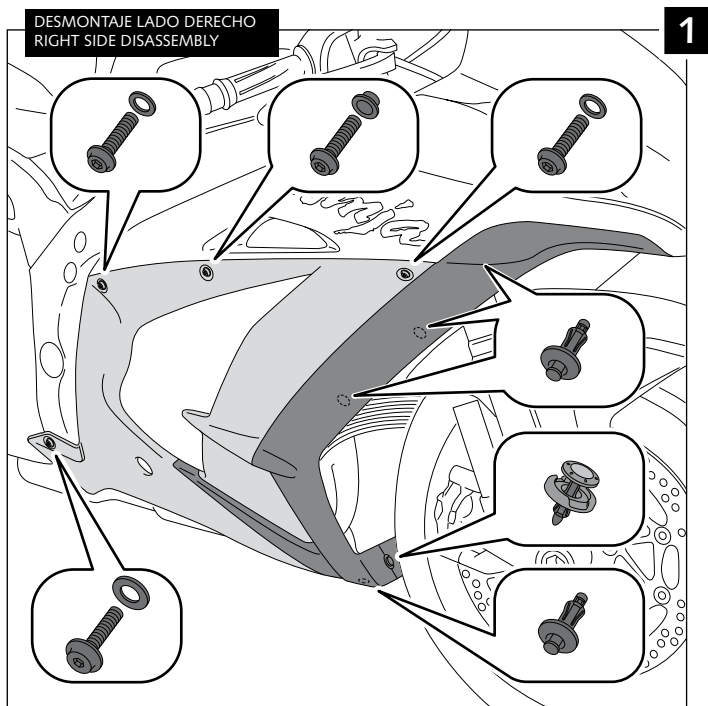

ALERONES LATERALES "DOWNFORCE" PARA - SIDE SPOILER "DOWNFORCE" -
SEITENFLÜGEL "DOWNFORCE"

KAWASAKI ZX-10R '11-

INSTRUCCIONES DE MONTAJE - MOUNTING INSTRUCTIONS - MONTAGEANLEITUNG

DESMONTAJE LADO DERECHO
RIGHT SIDE DISASSEMBLY

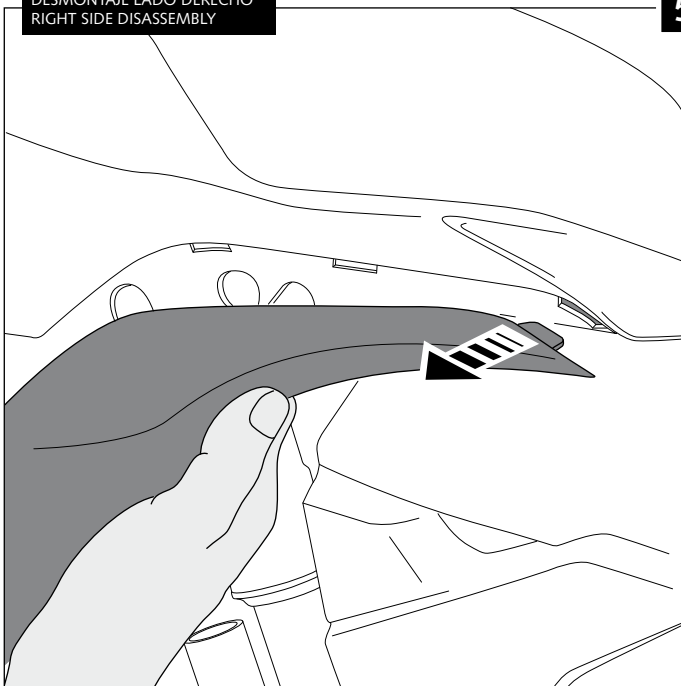

5

MONTAJE LADO DERECHO
RIGHT SIDE ASSEMBLY

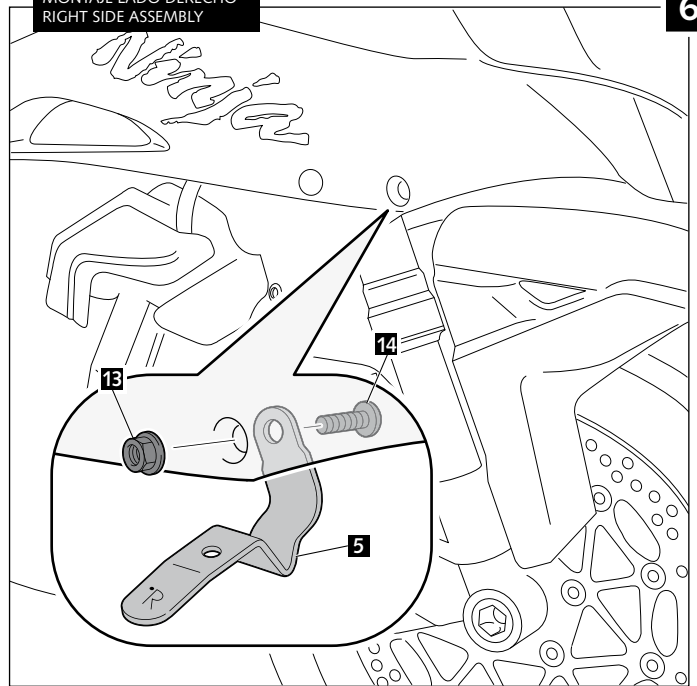

6

MONTAJE LADO DERECHO
RIGHT SIDE ASSEMBLY

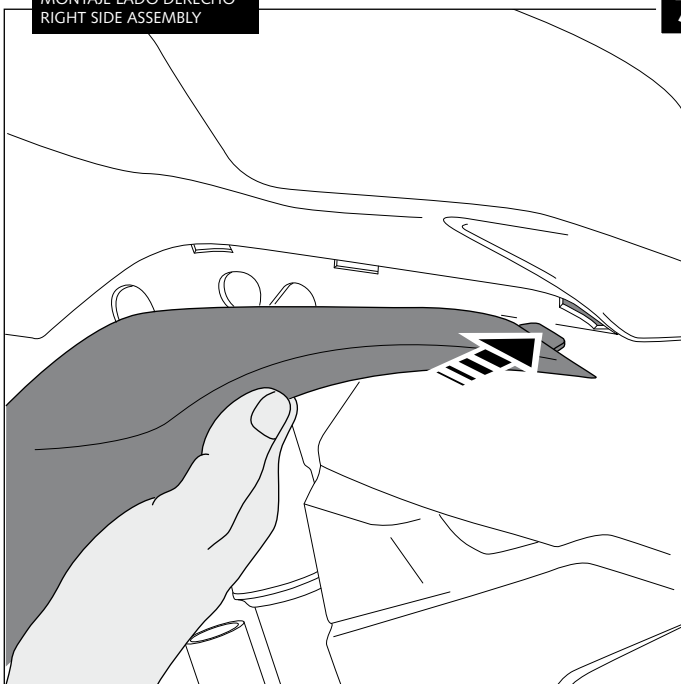

7

MONTAJE LADO DERECHO
RIGHT SIDE ASSEMBLY

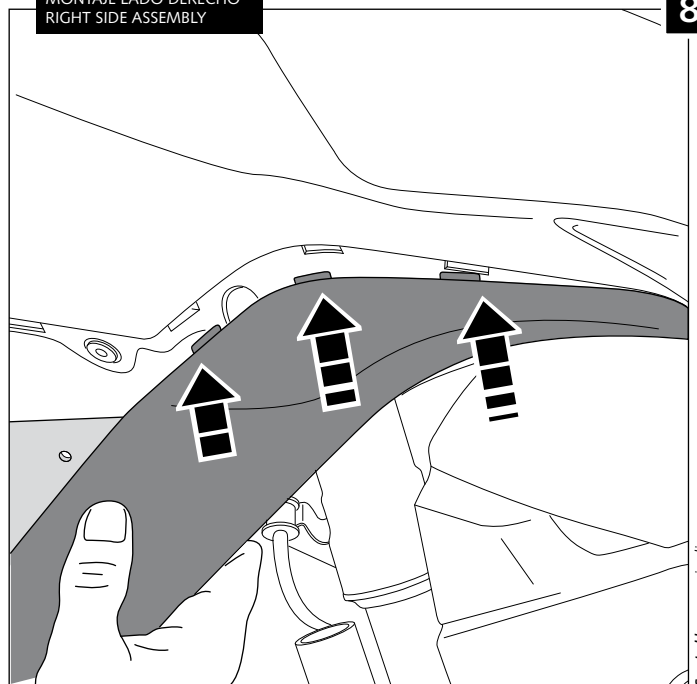

8

ALERONES LATERALES "DOWNFORCE" PARA - SIDE SPOILER "DOWNFORCE" -
 SEITENFLÜGEL "DOWNFORCE"
KAWASAKI ZX-10R '11-

INSTRUCCIONES DE MONTAJE - MOUNTING INSTRUCTIONS - MONTAGEANLEITUNG

MONTAJE LADO DERECHO
 RIGHT SIDE ASSEMBLY

9

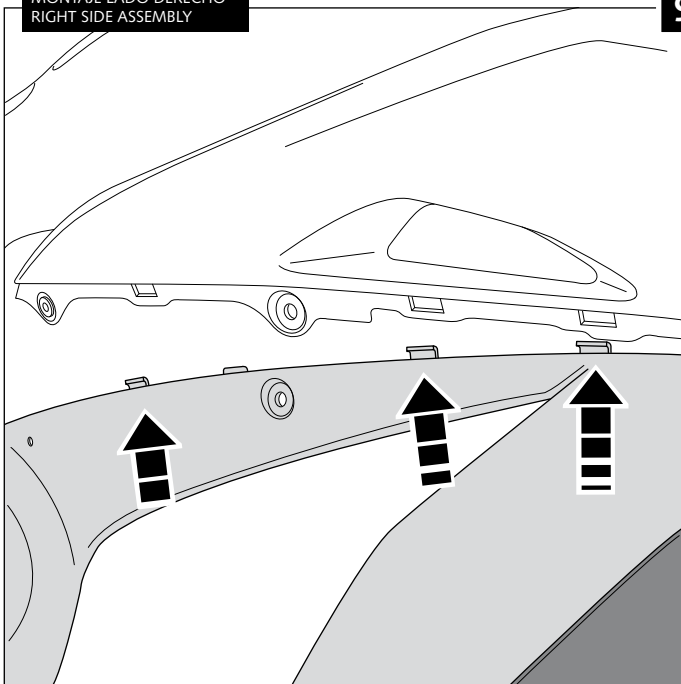

MONTAJE LADO DERECHO
 RIGHT SIDE ASSEMBLY

10

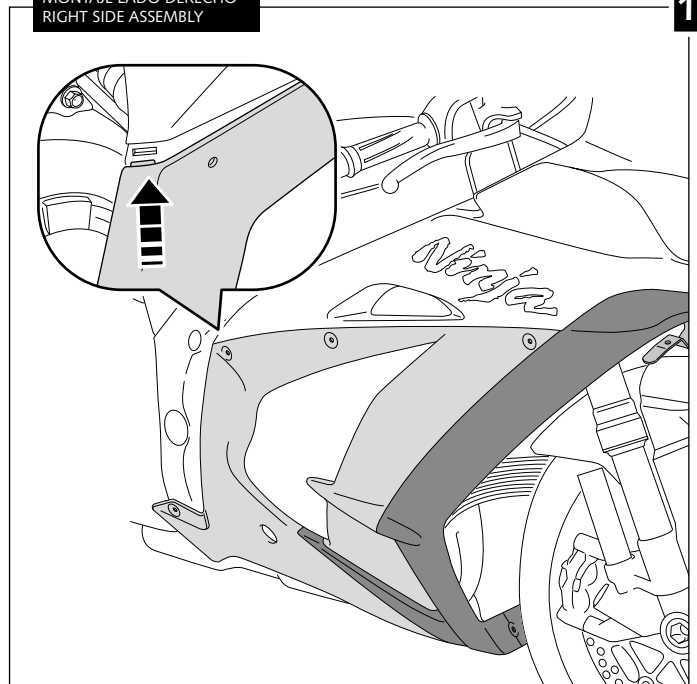

MONTAJE LADO DERECHO
 RIGHT SIDE ASSEMBLY

11

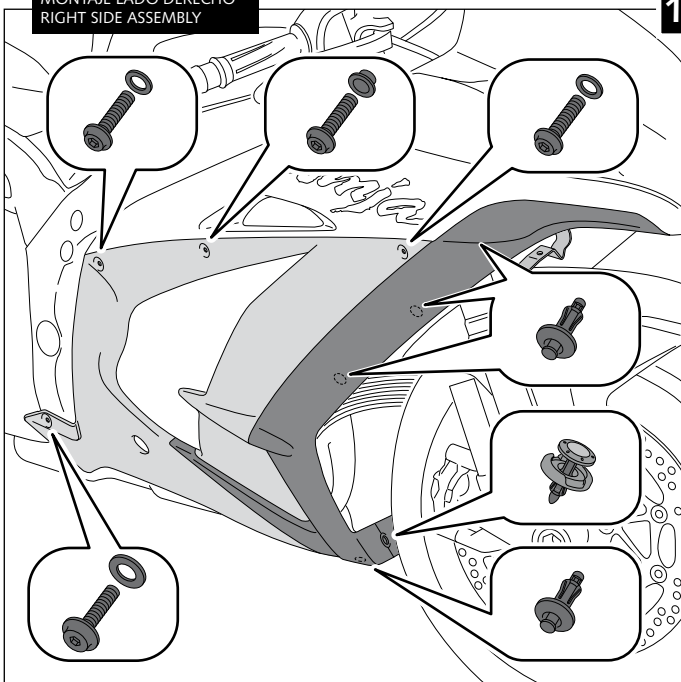

MONTAJE LADO DERECHO
 RIGHT SIDE ASSEMBLY

12

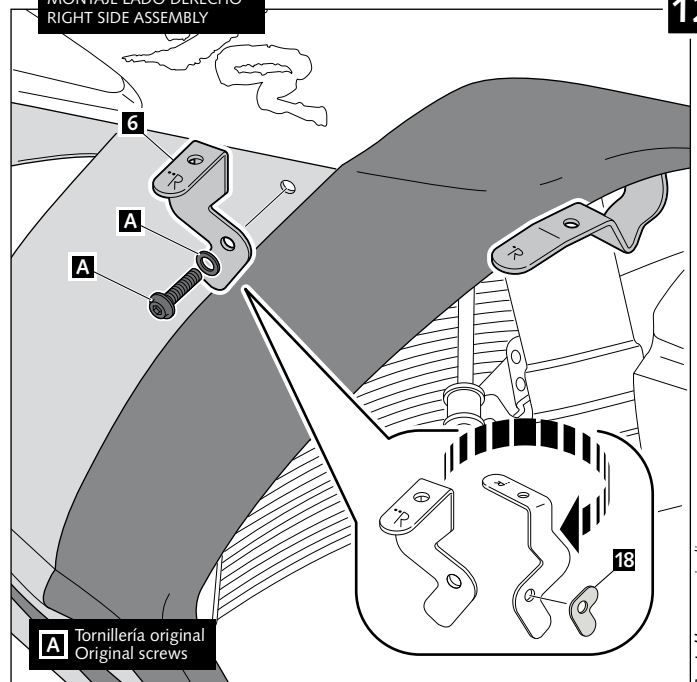

A Tornillería original
 Original screws

ALERONES LATERALES "DOWNFORCE" PARA - SIDE SPOILER "DOWNFORCE" -
 SEITENFLÜGEL "DOWNFORCE"

KAWASAKI ZX-10R '11-

INSTRUCCIONES DE MONTAJE - MOUNTING INSTRUCTIONS - MONTAGEANLEITUNG

MONTAJE LADO DERECHO
 RIGHT SIDE ASSEMBLY

13

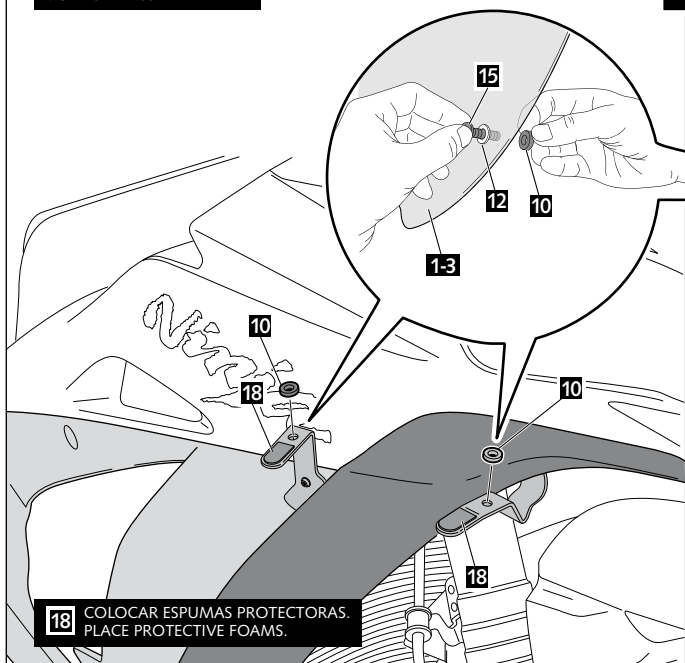

18 COLOCAR ESPUMAS PROTECTORAS.
 PLACE PROTECTIVE FOAMS.

MONTAJE LADO DERECHO
 RIGHT SIDE ASSEMBLY

14

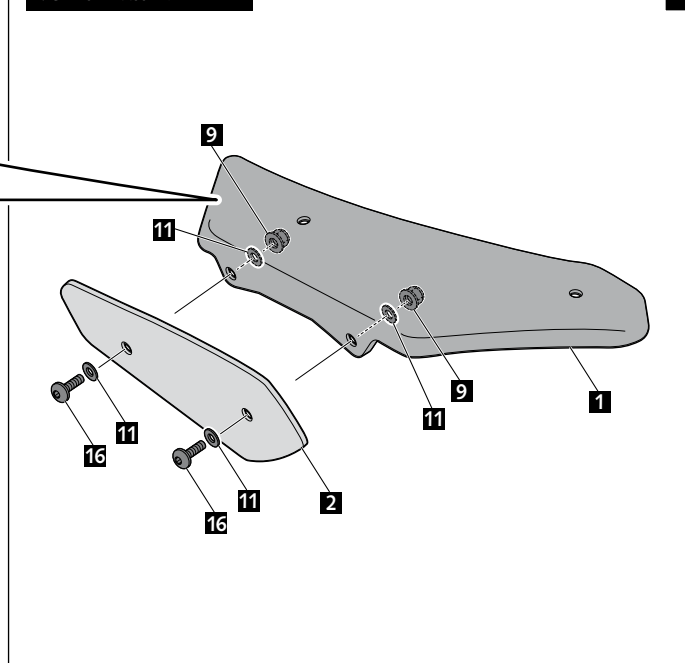

MONTAJE LADO DERECHO
 RIGHT SIDE ASSEMBLY

15

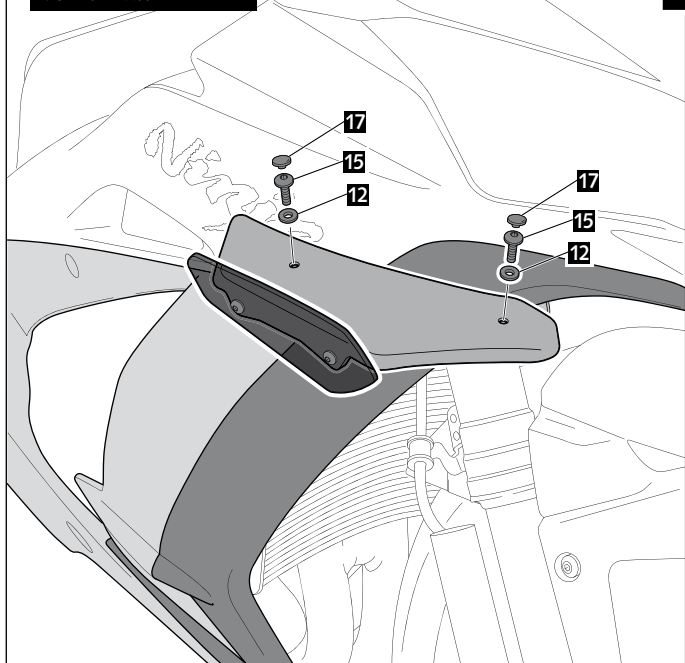

16

PARA MONTAR EL ALERÓN DEL LADO IZQUIERDO, SEGUIR EL MISMO
 PROCEDIMIENTO QUE EL LADO DERECHO.
 TO ASSEMBLE THE SPOILER ON THE LEFT SIDE, FOLLOW THE SAME
 PROCEDURE AS THE RIGHT SIDE