

HONDA CBR650R '24-

M O U N T I N G I N S T R U C T I O N S

REF 22661

FRONTAL SPOILER GP

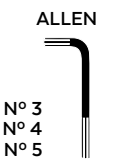
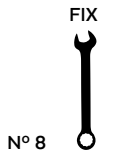

ID.	PIEZA/PART	DESCRIPCIÓN	DESCRIPTION	QTY.	REF.:
1		Alerón frontal GP	Frontal spoiler GP	1	22661J/N/CM3
2		Soporte Izquierdo (L)	Left support	1	SOPOR2P3-L22661
3		Soporte derecho (R)	Right support	1	SOPOR2P3-R22661
4		Arandela de nylon Ø6,2xØ12x3mm	Ø6,2xØ12x3mm Nylon washer	4	ARAND-----749
5		Tornillo Allen M5x16 Ø11 ISO 7380	M5x16 Ø11 ISO 7380 Allen screw	2	TORNI-I7380-493
6		Tuerca grafilada M5	M5 Nut	2	TUERC-D6923-255
7		Tuerca de clip M6	M6 Clip nut	2	TUERCA-TRT-M6--
8		Tornillo Allen M6x16 Ø14 ISO7380	M6x16 Ø14 ISO7380 Allen screw	2	TORNI-I7380-403
9		Tope de goma Ø3,7-3,8 x 3,2mm	Ø3,7-3,8 x 3,2mm Bumper foot	2	TOPE--POF-40022
10		Tornillo Allen M5x12 DIN7991	M5x12 DIN7991 Allen screw	4	TORNI-D7991-611
11		Tapón tornillo M5 DIN7991	M5 DIN7991 screw cap	4	TAPON-----92
12		Arandela de goma Ø4,5x Ø11x 2mm	Ø4,5x Ø11x 2mm Rubber washer	2	ARAND-EPDM--722

HONDA CBR650R '24-

INSTRUCCIONES DE MONTAJE - MOUNTING INSTRUCTIONS - MONTAGEANLEITUNG

1

**DISASSEMBLY
DESMONTAJE**

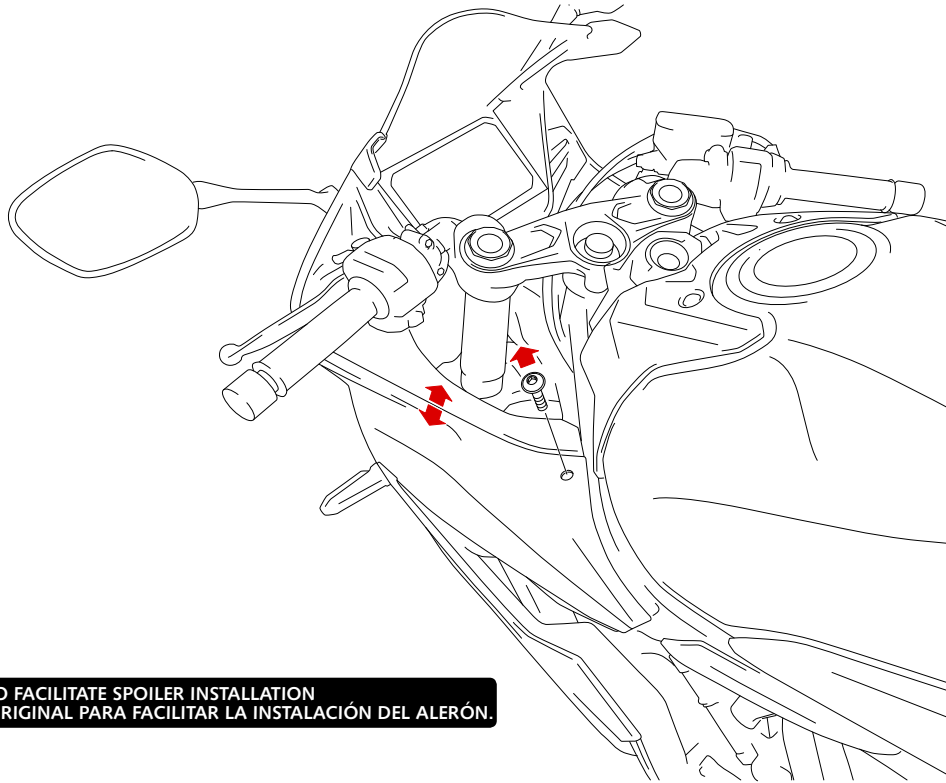

REMOVE ORIGINAL SCREW TO FACILITATE SPOILER INSTALLATION
DESATORNILLAR TORNILLO ORIGINAL PARA FACILITAR LA INSTALACIÓN DEL ALERÓN.

2

**DISASSEMBLY
DESMONTAJE**

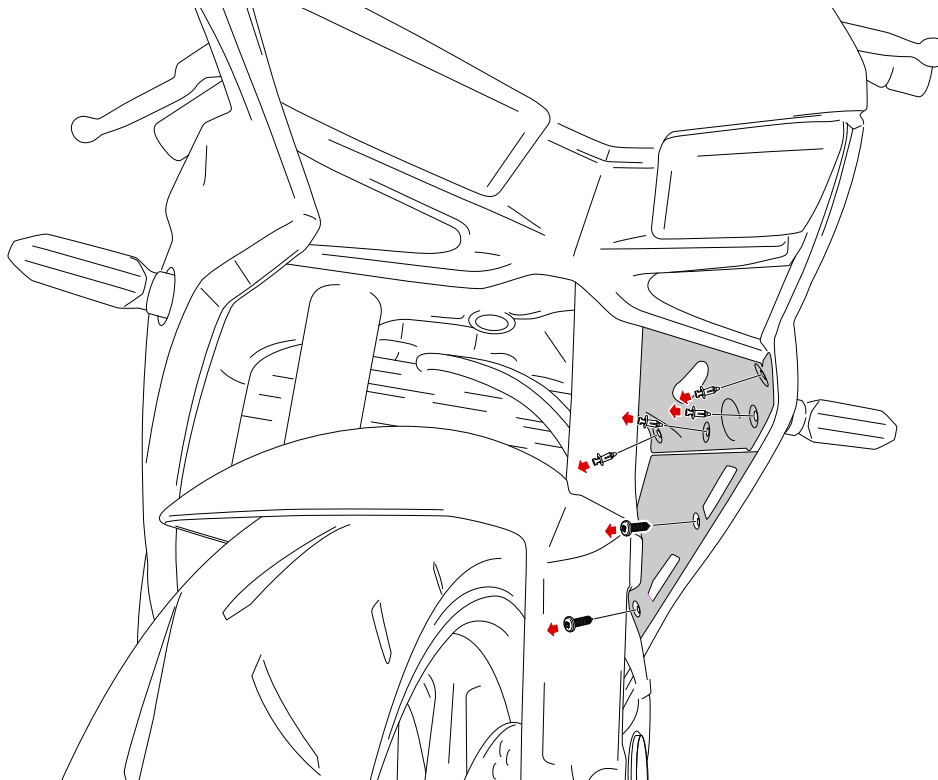

HONDA CBR650R '24-

INSTRUCCIONES DE MONTAJE - MOUNTING INSTRUCTIONS - MONTAGEANLEITUNG

3

ASSEMBLY
MONTAJE

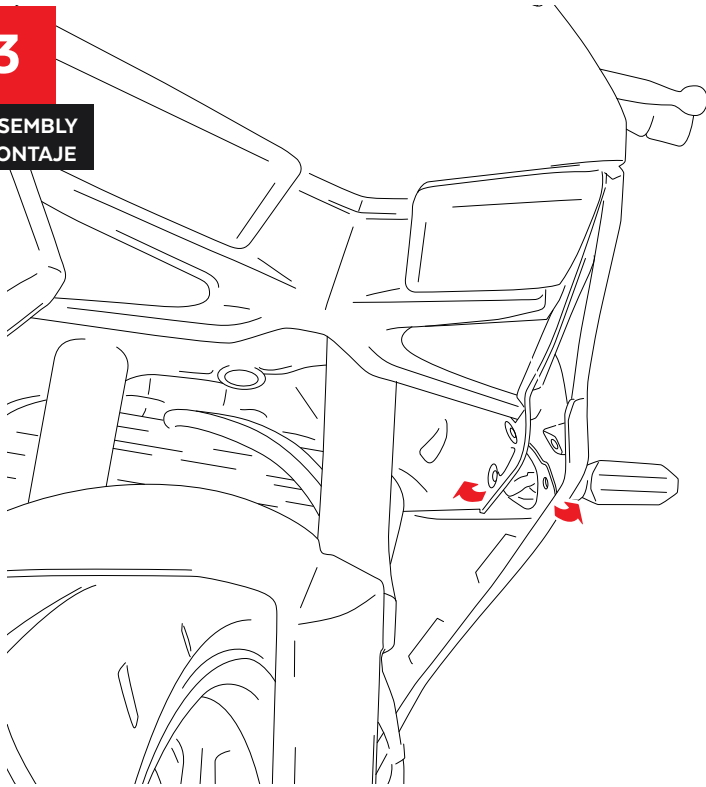

4

ASSEMBLY
MONTAJE

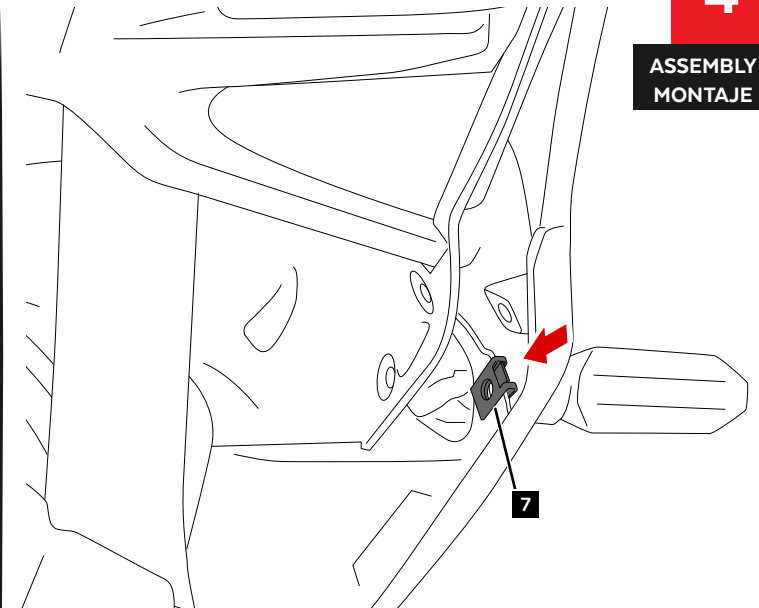

ASEGURAR QUE LA TUERCA CLIP ID.7 NO MOLESTA EN EL MONTAJE DE LAS TAPAS ORIGINALES
TO ENSURE THE ID.7 CLIP NUT DOESN'T INTERFERE WITH THE ASSEMBLY OF THE ORIGINALS COVERS.

5

ASSEMBLY
MONTAJE

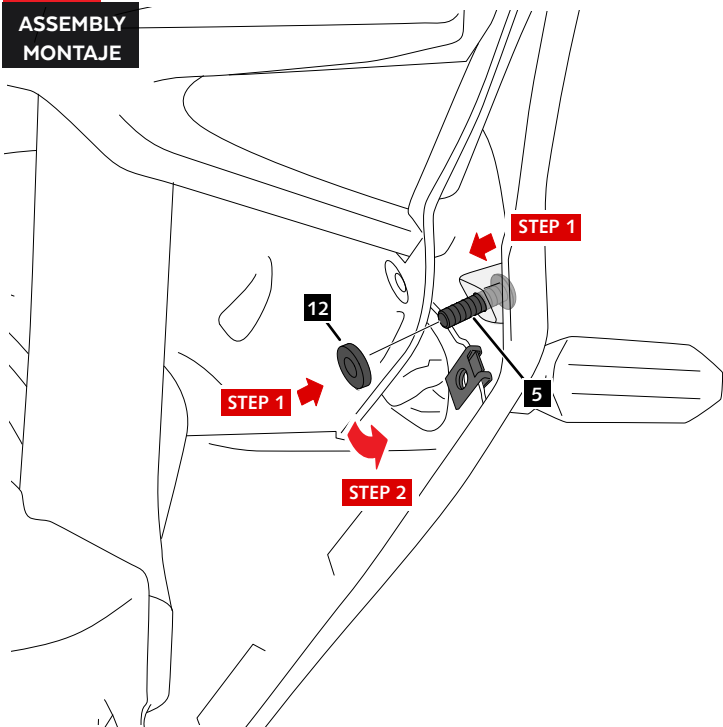

6

ASSEMBLY
MONTAJE

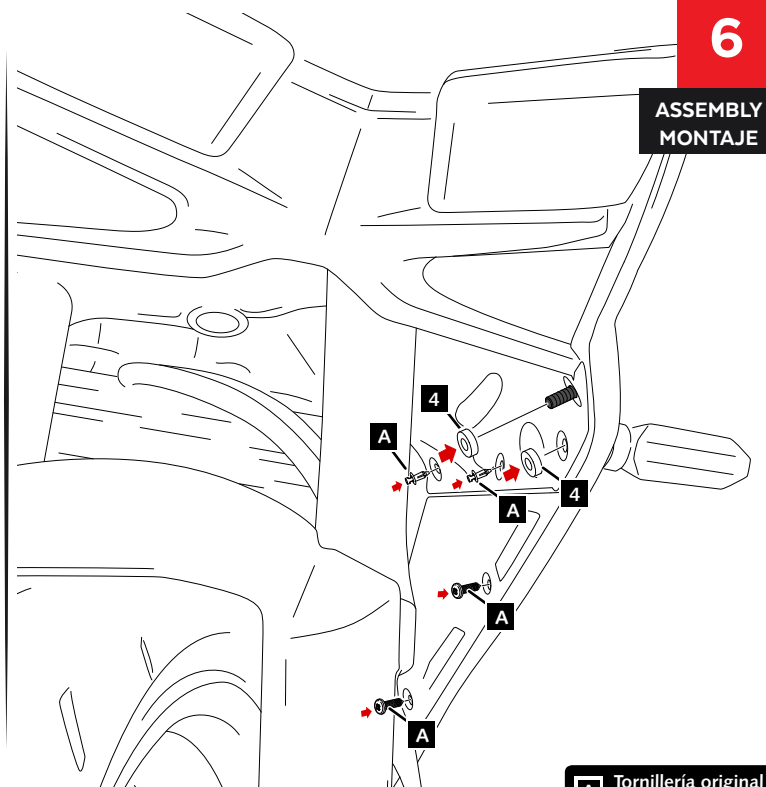

A Tornillería original
Original screws

HONDA CBR650R '24-

INSTRUCCIONES DE MONTAJE - MOUNTING INSTRUCTIONS - MONTAGEANLEITUNG

7

ASSEMBLY
MONTAJE

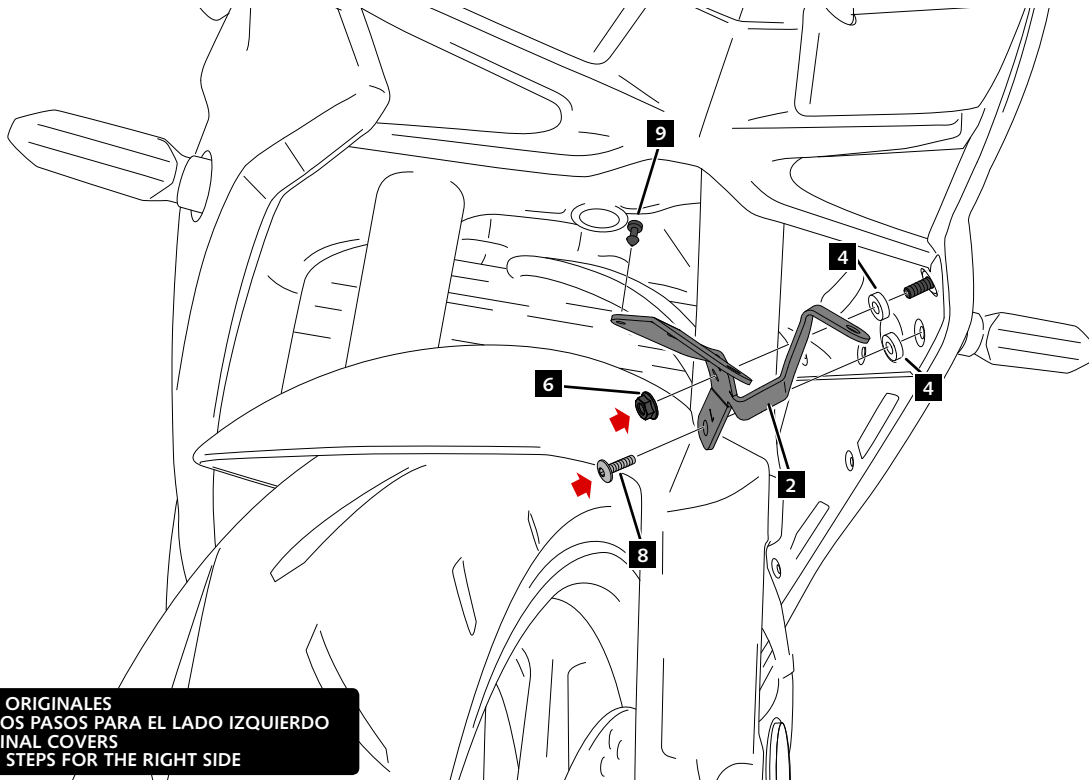

MONTAR LAS TAPAS ORIGINALES
REALIZAR LOS MISMOS PASOS PARA EL LADO IZQUIERDO
ASSEMBLY THE ORIGINAL COVERS
PERFORM THE SAME STEPS FOR THE RIGHT SIDE

8

ASSEMBLY
MONTAJE

