

# KAWASAKI Z650 '20-

## M O U N T I N G I N S T R U C T I O N S

REF 22472

D12 SPOILERS



ID	PIEZA/PART	DESCRIPCIÓN	DESCRIPTION	QTY	REF
1		Alerón izquierdo	Left spoiler	1	22472J/N/CM3
2		Alerón derecho	Right spoiler	1	22472J/N/CM3
3		Soporte izquierdo ( L )	Left support ( L )	1	SOPOR2P3-L22472
4		Soporte derecho ( R )	Right support ( R )	1	SOPOR2P3-R22472
5		Tope de goma Ø11x Ø5,5x 7mm	Ø11x Ø5,5x 7mm Bumper foot	2	TOPEGOMA--22384
6		Tornillo Allen M5x35 Ø11 ISO 7380	M5x35 Ø11 ISO 7380 Allen screw	1	TORNI-I7380-499
7		Casquillo Ø8,5x Ø13x 20mm	Ø8,5x Ø13x 20mm Arrowhead	1	CASQUI-----586
8		Tornillo Allen M5x30 Ø11 ISO 7380	M5x30 Ø11 ISO 7380 Allen screw	2	TORNI-I7380-767
9		Casquillo Ø8,5 x Ø13x 15mm	Ø8,5 x Ø13x 15mm Arrowhead	1	CASQUI-M----614
10		Casquillo Ø5 x Ø9x 13mm	Ø5 x Ø9x 13mm Arrowhead	1	CASQUI-----713
11		Tornillo Allen M5x60 Ø11 ISO 7380	M5x60 Ø11 ISO 7380 Allen screw	1	TORNI-I7380-956
12		Casquillo Ø8,5 x Ø13x 34mm	Ø8,5 x Ø13x 34mm Arrowhead	1	CASQUI-----962
13		Tornillo M5x12 DIN7991	M5x12 DIN7991 Allen screw	4	TORNI-D7991-611
14		Arandela de goma Ø4,5 x Ø11 x 2mm	Ø4,5 x Ø11 x 2mm Rubber washer	4	ARAND-EPDM--722
15		Tapón tornillo M5 DIN7991	M5 DIN7991 screw cap	4	TAPON-----92

# KAWASAKI Z650 '20-

INSTRUCCIONES DE MONTAJE - MOUNTING INSTRUCTIONS - MONTAGEANLEITUNG

**1**

**DISASSEMBLY  
DESMONTAJE**

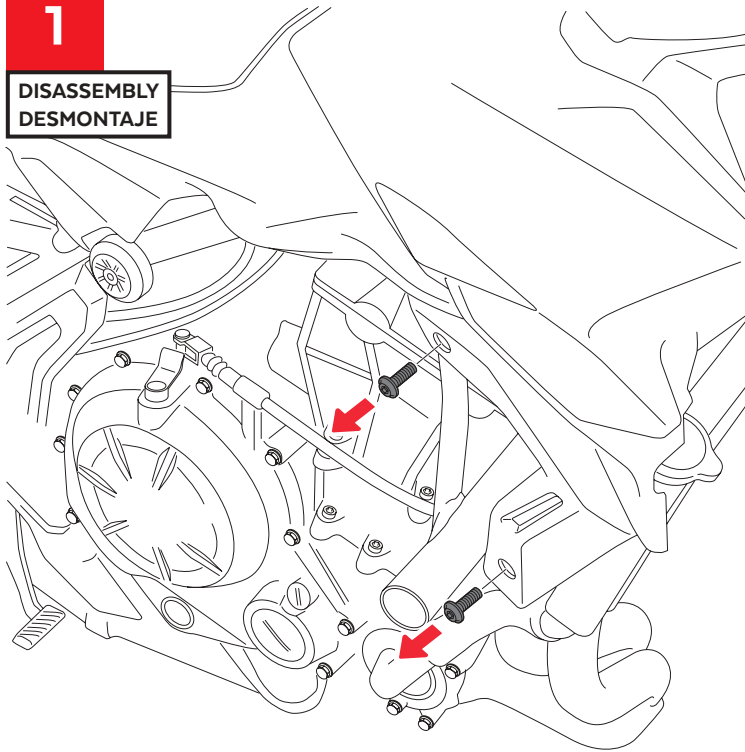

**2**

**ASSEMBLY  
MONTAJE**

**6** Par de apriete - 2 Nm  
Tightening torque - 2 Nm

**8** Par de apriete - 3 Nm  
Tightening torque - 3 Nm

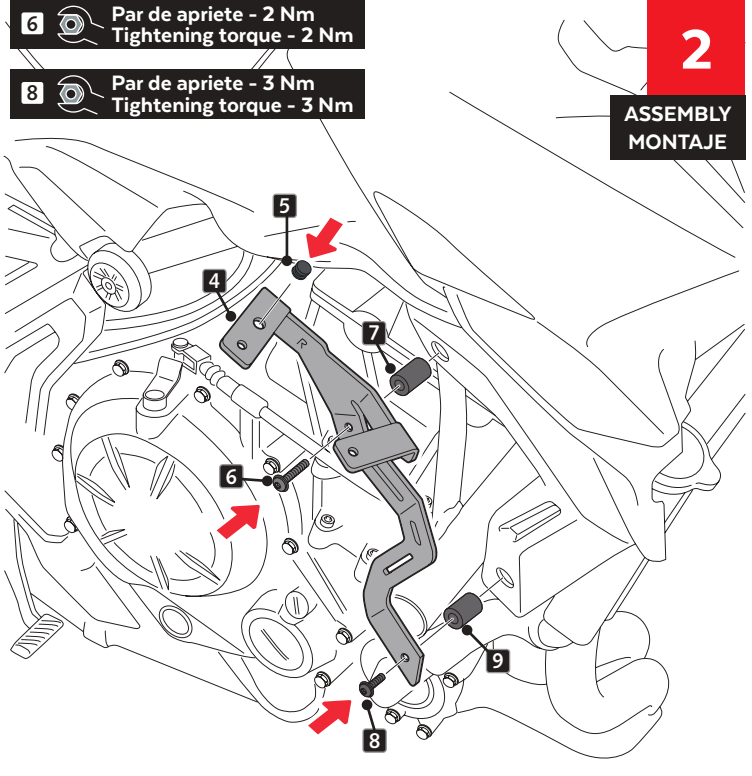

**3**

**ASSEMBLY  
MONTAJE**

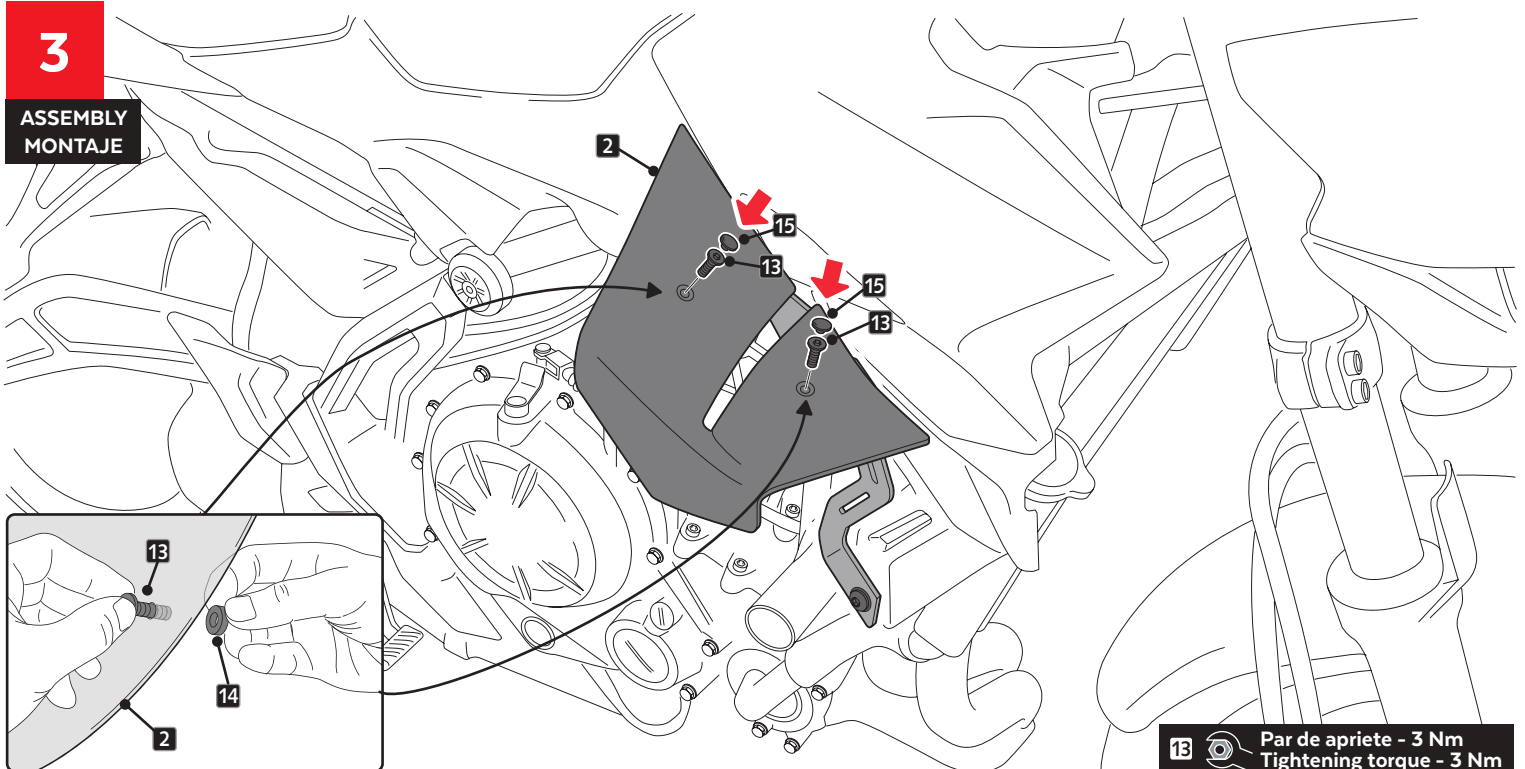

**13** Par de apriete - 3 Nm  
Tightening torque - 3 Nm

# KAWASAKI Z650 '20-

INSTRUCCIONES DE MONTAJE - MOUNTING INSTRUCTIONS - MONTAGEANLEITUNG

**4**

DISASSEMBLY  
DESMONTAJE

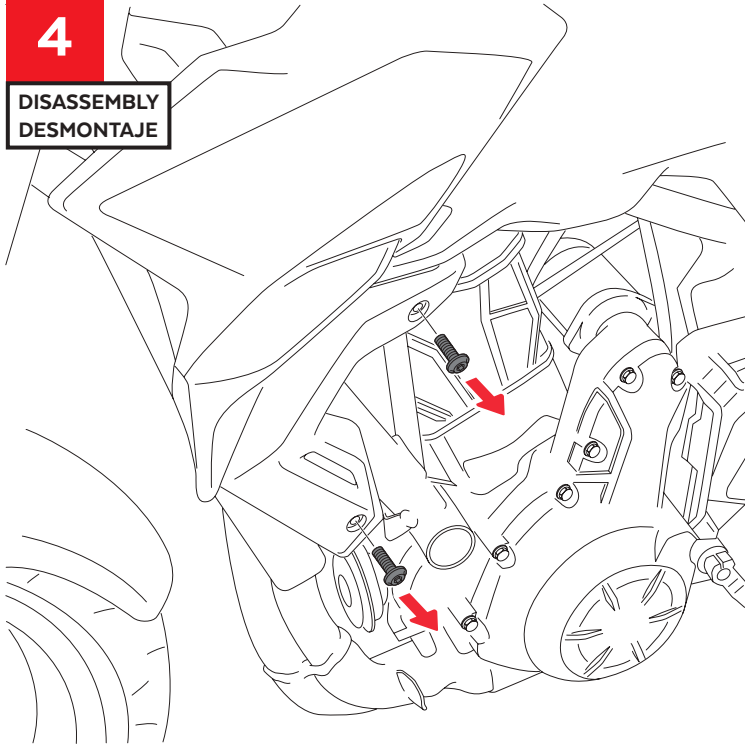

**11** Par de apriete - 2 Nm  
Tightening torque - 2 Nm

**8** Par de apriete - 3 Nm  
Tightening torque - 3 Nm

**5**

ASSEMBLY  
MONTAJE

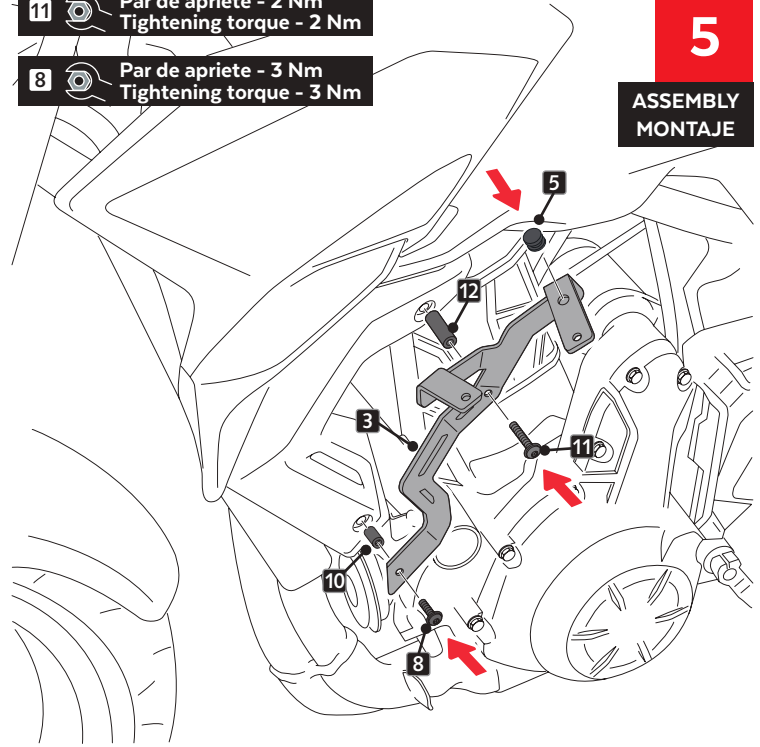

**6**

ASSEMBLY  
MONTAJE

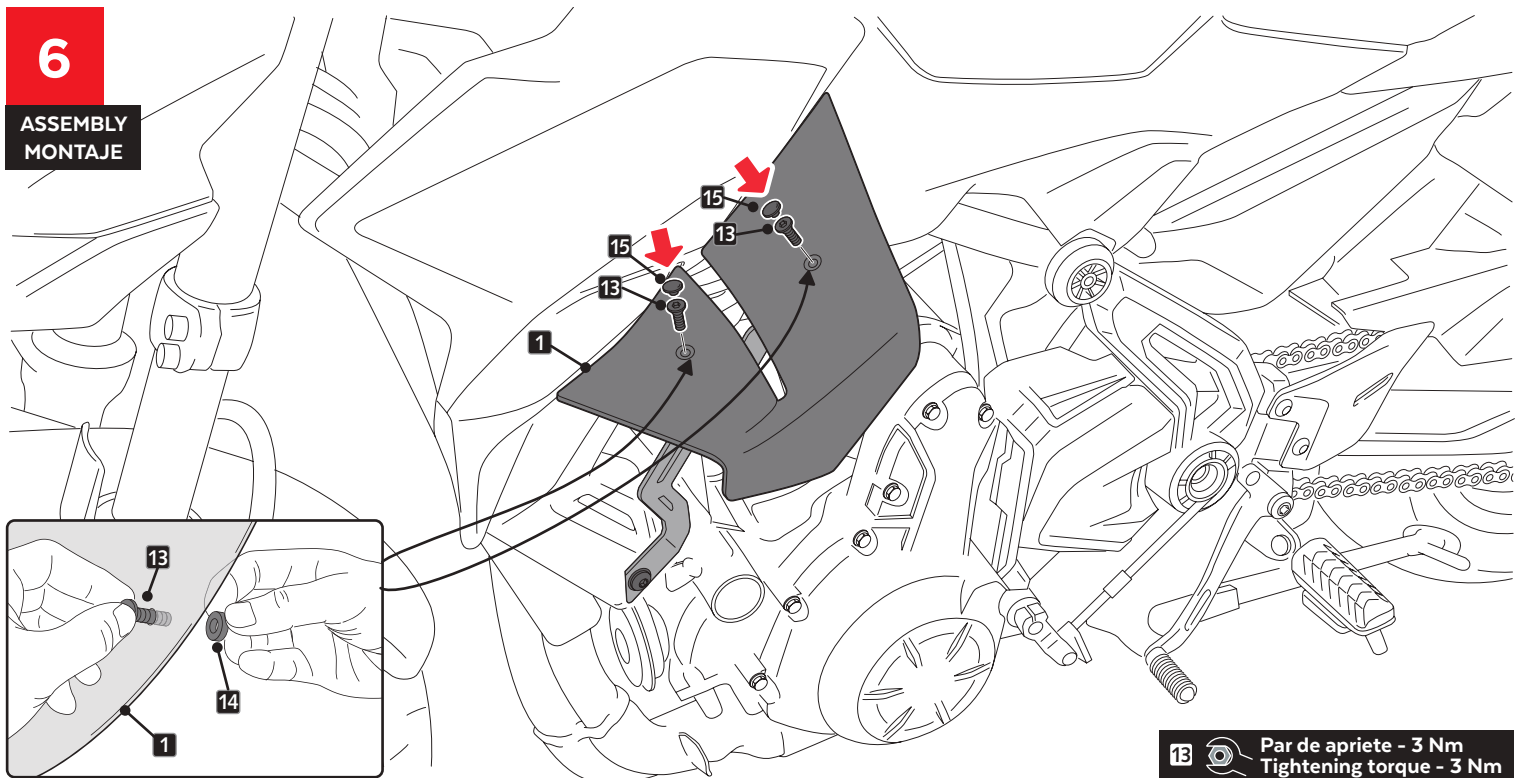

**13** Par de apriete - 3 Nm  
Tightening torque - 3 Nm