

# HONDA CB750 HORNET '25-

## M O U N T I N G I N S T R U C T I O N S

REF 22426

D12 SPOILERS



1 Person



30 min



EASY



ALLEN  
Nº 3  
Nº 5

| ID | PIEZA/PART | DESCRIPCIÓN                       | DESCRIPTION                    | QTY | REF             |
|----|------------|-----------------------------------|--------------------------------|-----|-----------------|
| 1  |            | Alerón Izquierdo                  | Left spoiler                   | 1   | 22426J/N/CM3    |
| 2  |            | Alerón Derecho                    | Right spoiler                  | 1   | 22426J/N/CM3    |
| 3  |            | Soporte izquierdo ( L )           | Left support ( L )             | 1   | SOPOR2P3-L22426 |
| 4  |            | Soporte derecho ( R )             | Right support ( R )            | 1   | SOPOR2P3-R22426 |
| 5  |            | Tope de goma Ø10,5 xØ7,9 mm       | Ø10,5 xØ7,9 mm bumper foot     | 2   | TAPON-----95    |
| 6  |            | Tuerca de clip M5                 | M5 clip nut                    | 2   | TUERCA-TRT-M5-- |
| 7  |            | Casquillo Ø8x Ø13x 9mm            | Ø8x Ø13x 9mm arrowhead         | 2   | CASQUI-----777  |
| 8  |            | Tornillo Allen M5x20 Ø11 ISO 7380 | M5x20 Ø11 ISO 7380 Allen screw | 2   | TORNI-I7380-730 |
| 9  |            | Tornillo Allen M5x12 DIN7991      | M5x12 DIN7991 Allen screw      | 4   | TORNI-D7991-611 |
| 10 |            | Arandela de goma Ø4,5 x Ø11 x 2mm | Ø4,5 x Ø11 x 2mm rubber washer | 4   | ARAND-EPDM--722 |
| 11 |            | Tapón tornillo M5 DIN7991         | M5 DIN7991 screw cap           | 4   | TAPON-----92    |

\* Algunos componentes se suministran montados.  
Some components are supplied assembled.

# HONDA CB750 HORNET '25-

INSTRUCCIONES DE MONTAJE - MOUNTING INSTRUCTIONS - MONTAGEANLEITUNG

**1**

DISASSEMBLY  
DESMONTAJE

Se muestra el montaje del lado derecho a modo de ejemplo, realizar los mismos pasos para el montaje del lado izquierdo.  
The right side assembly is shown as an example, so the same steps can be performed for the left side assembly.

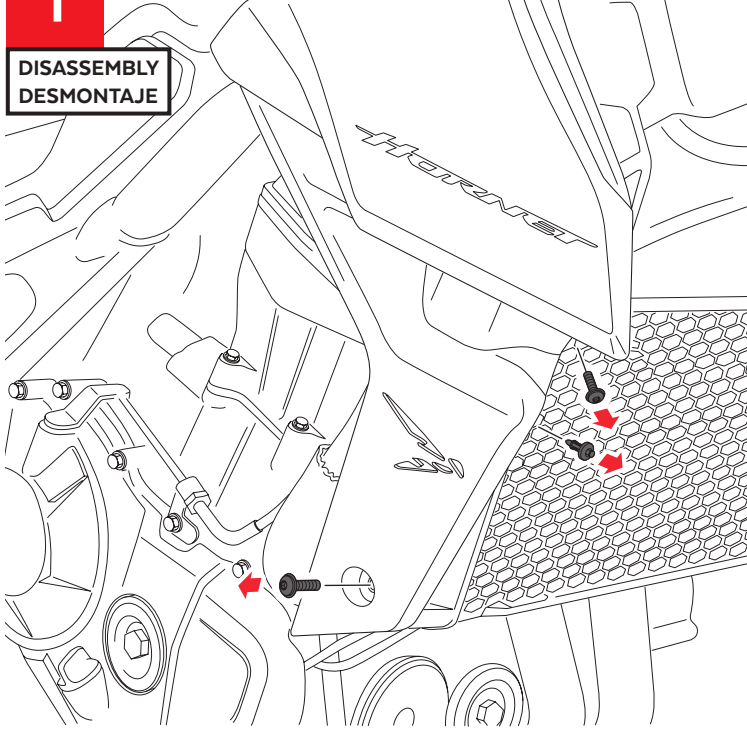

**2**

ASSEMBLY  
MONTAJE

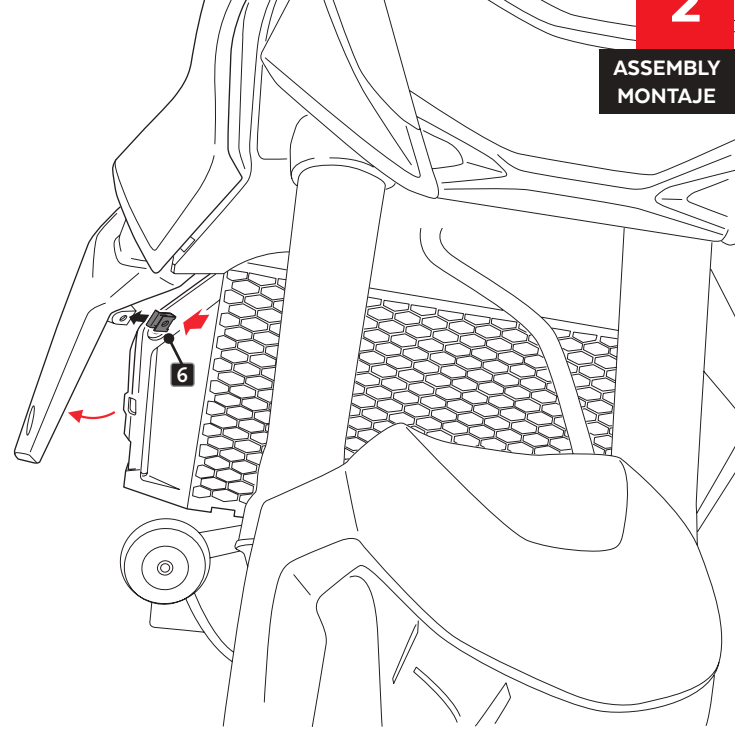

**3**

ASSEMBLY  
MONTAJE

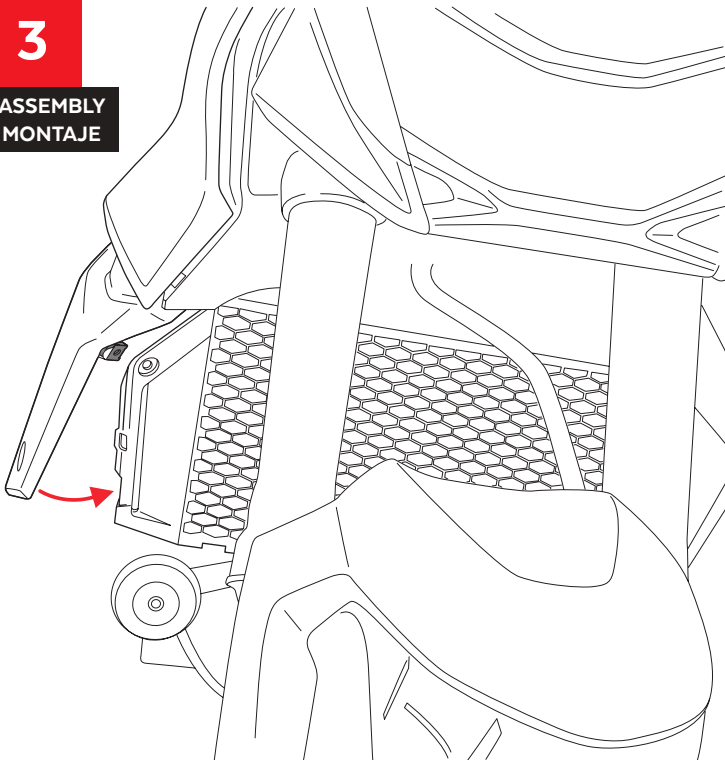

**4**

ASSEMBLY  
MONTAJE

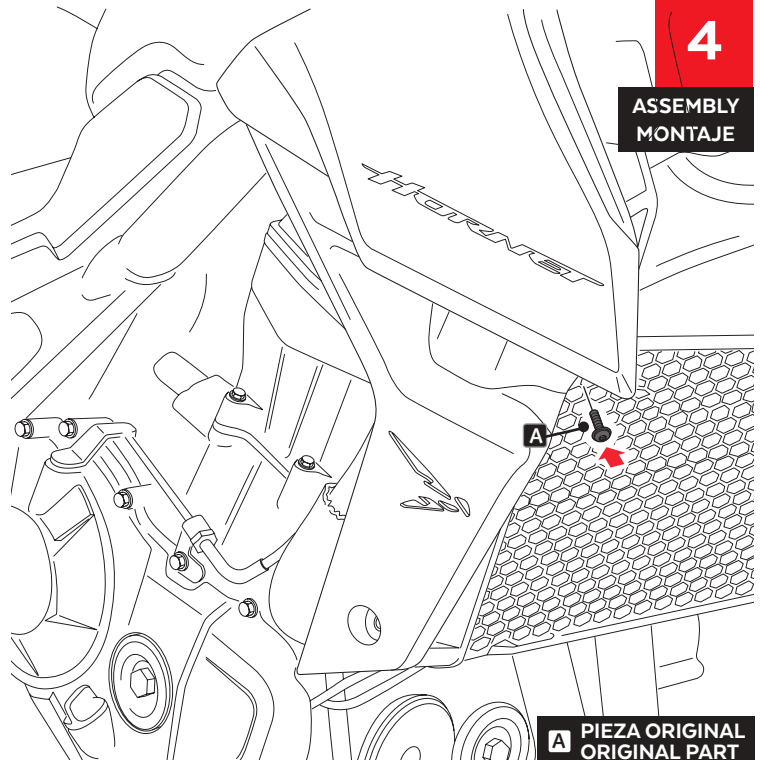

**A** PIEZA ORIGINAL  
ORIGINAL PART

# HONDA CB750 HORNET '25-

INSTRUCCIONES DE MONTAJE - MOUNTING INSTRUCTIONS - MONTAGEANLEITUNG

**5**

ASSEMBLY  
MONTAJE

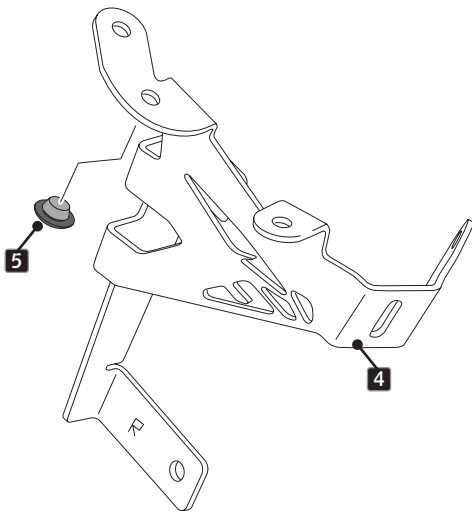

**6**

ASSEMBLY  
MONTAJE

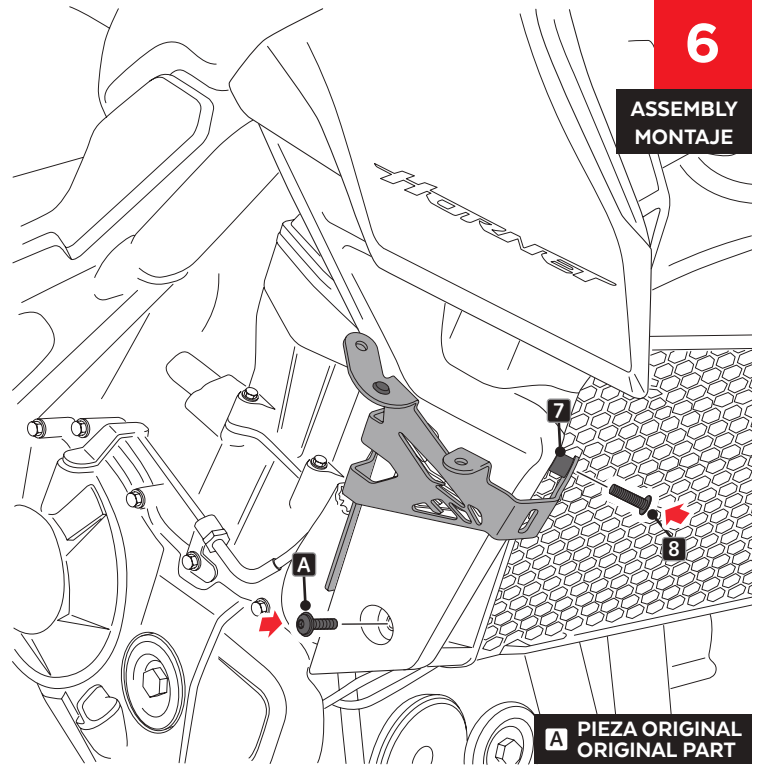

**7**

ASSEMBLY  
MONTAJE

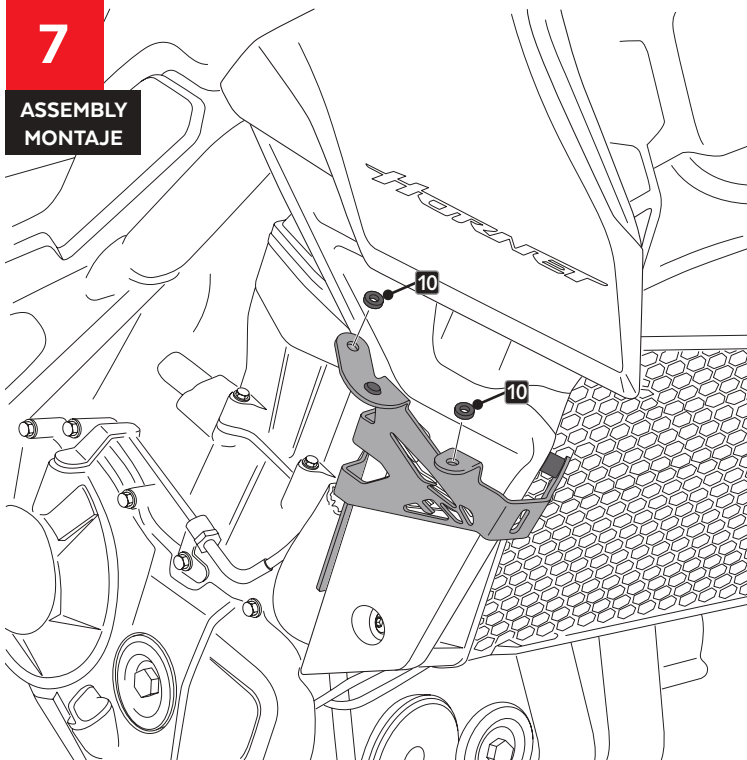

**8**

ASSEMBLY  
MONTAJE

