

# BMW R1300GS PISTA

REF 22350N

PORTAMATRÍCULA / LICENSE SUPPORT / KENNZEICHENHALTER



1 Person







1 hour

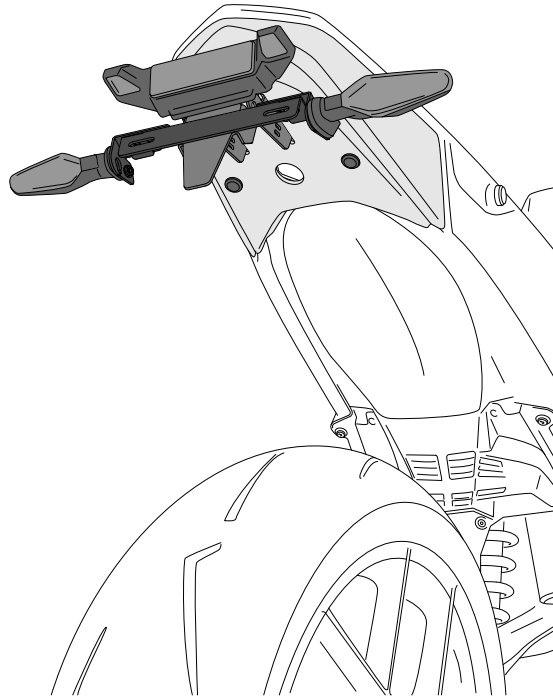

INTERMEDIATE

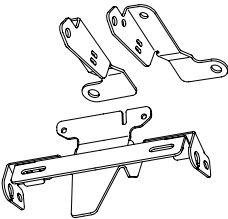

Accesorio verificado en la configuración básica de la motocicleta. Para modelos con configuraciones extras de fábrica. No podemos asegurar su compatibilidad, salvo consulta previa. Declinamos cualquier eventual reclamación.  
Accessory verified in the basic configuration of the motorcycle. For models with extra factory settings. We cannot assure its compatibility, except for prior consultation. We decline any eventual claim.

ID.	PIEZA / PART	DESCRIPCIÓN	DESCRIPTION	QTY.	REF.:
1		Soporte portamatrículas	License support	1	CONJUNTO-22350N
2		Brida de plástico	Plastic bridge	5	BRIDAN100X2'5N
3		Tapón cabota tornillo M6 DIN1001	M6 DIN1001 screw cap	4	TAPON-----85
4		Tapón cabota tornillo M5 DIN1001	M5 DIN1001 screw cap	1	TAPON-----86

# BMW R1300GS PISTA

REF  
22350N

INSTRUCCIONES DE MONTAJE - MOUNTING INSTRUCTIONS - MONTAGEANLEITUNG

1

ASSEMBLY  
MONTAJE

**A** Piezas originales  
Original parts

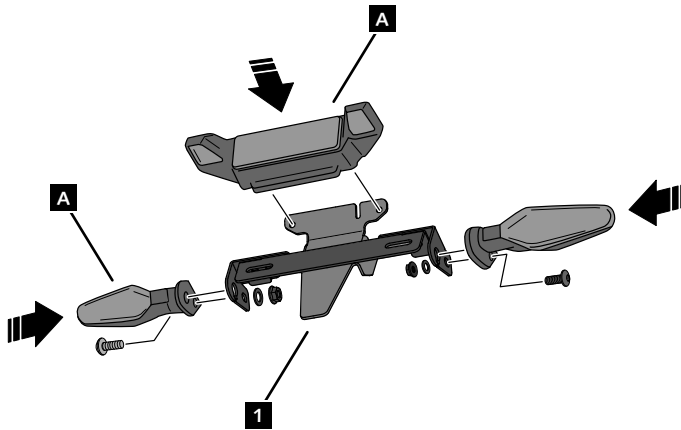

2

ASSEMBLY  
MONTAJE

**B** Ref. 22312  
(Not included)

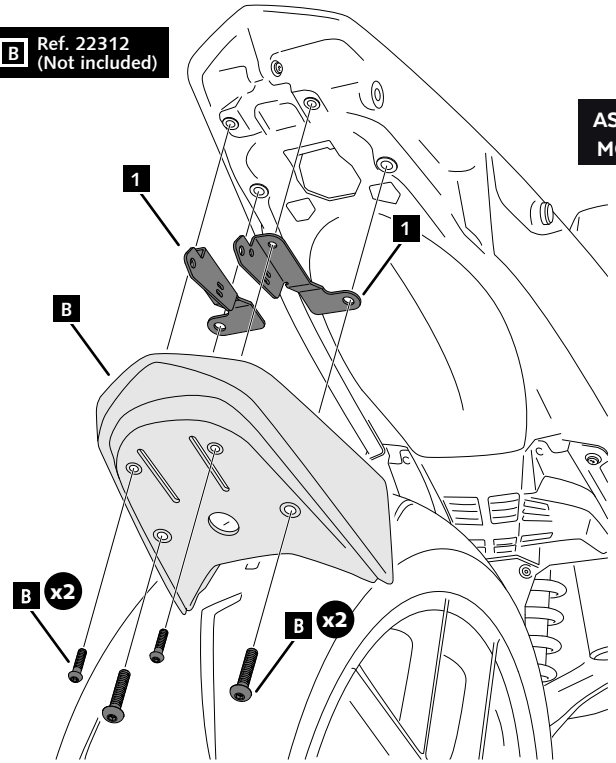

3

ASSEMBLY  
MONTAJE

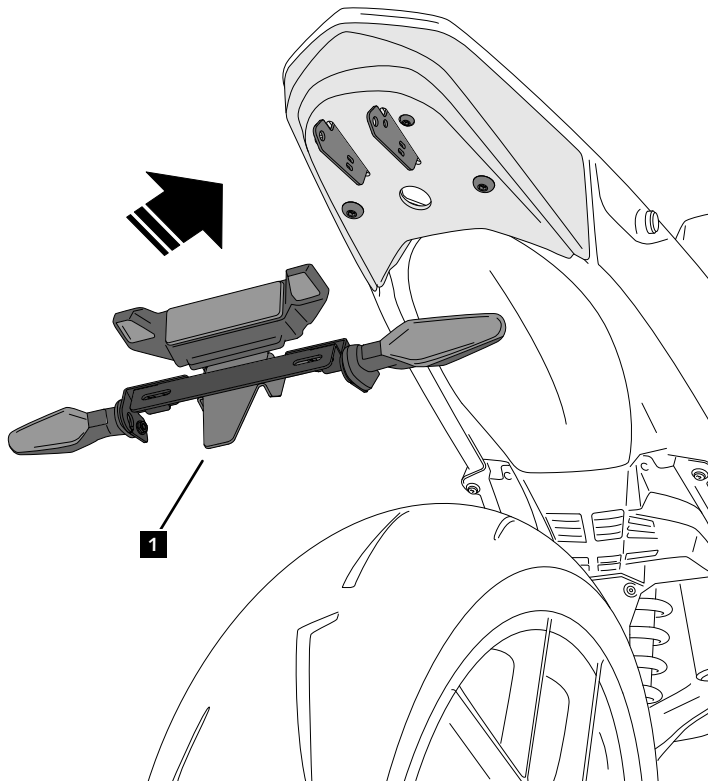

!

Utilizar los tornillos proporcionados en la REF.22312N. El portamatriculas debe ser montado junto con la tapa posterior de la REF.22312N.

Use the screws provided with REF.22312N. The license plate holder must be mounted together with the rear cover of REF.22312N