

TRIUMPH
TIGER 900 /GT /GT PRO/ GT LOW '20-/ TIGER 850 SPORT '21-

M O U N T I N G I N S T R U C T I O N S

REF 22330

UPPER DEFLECTORS / DEFLECTORES SUPERIORES

! NOT COMPATIBLE WITH THE RALLY/RALLY PRO MODELS



RATCHET

ALLEN

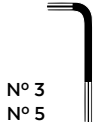

FLEXIBLE
EXTENSION BAR



ID.	PIEZA/PART	DESCRIPCIÓN	DESCRIPTION	QTY.	REF.:
1		Deflector izquierdo	Left Deflector	1	22330H/W/FM3
2		Deflector derecho	Right Deflector	1	22330H/W/FM3
3		Arandela de nylon M5	M5 Nylon washer	4	ARNV00000000309
4		Tornillo allen M5x14 ISO 7380	M5x14 ISO 7380 Allen screw	4	TORNI-I7380-610
5		Tornillo allen M5x25 Ø11 ISO 7380	M5x25 Ø11 ISO 7380 Allen screw	2	TORNI-I7380-766
6		Casquillo Ø 6,5x Ø 13x 8,5mm	Casquillo Ø 6,5x Ø 13x 8,5mm	2	CASQUI-----0298

TRIUMPH
TIGER 900 /GT /GT PRO/ GT LOW '20-/ TIGER 850 SPORT '21-

INSTRUCCIONES DE MONTAJE - MOUNTING INSTRUCTIONS - MONTAGEANLEITUNG

1

DISASSEMBLY
DESMONTAJE

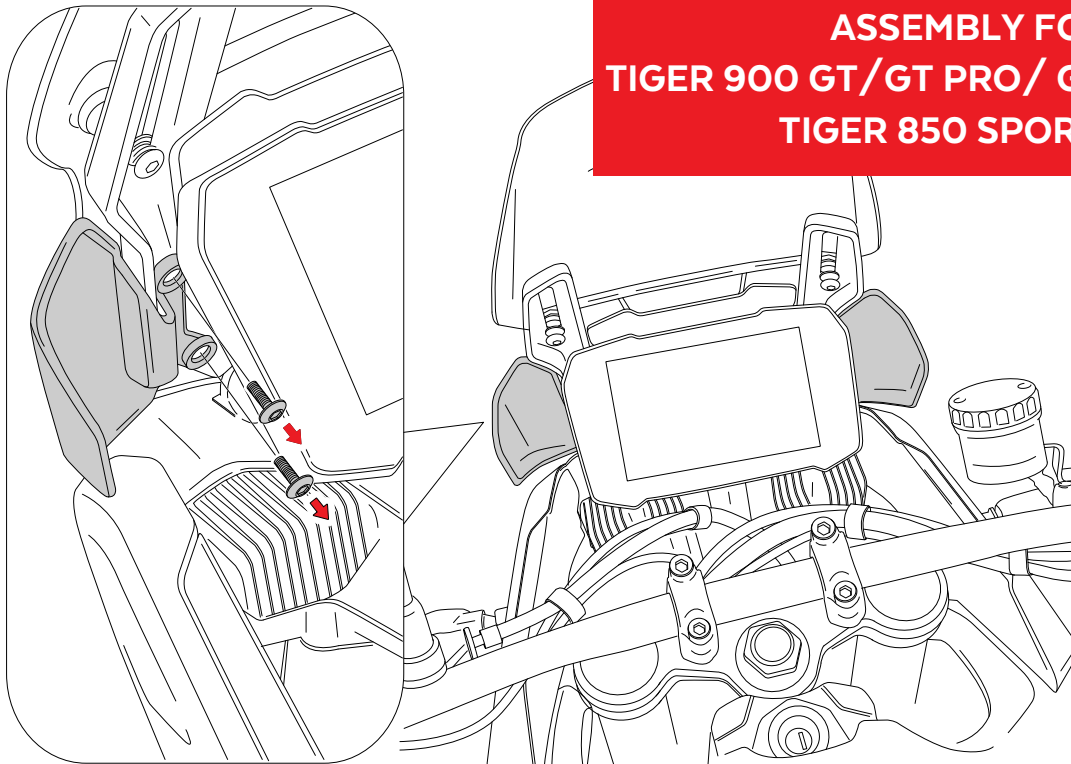

ASSEMBLY FOR
TIGER 900 GT/GT PRO/ GT LOW '20-'23
TIGER 850 SPORT '21-

2

ASSEMBLY
MONTAJE

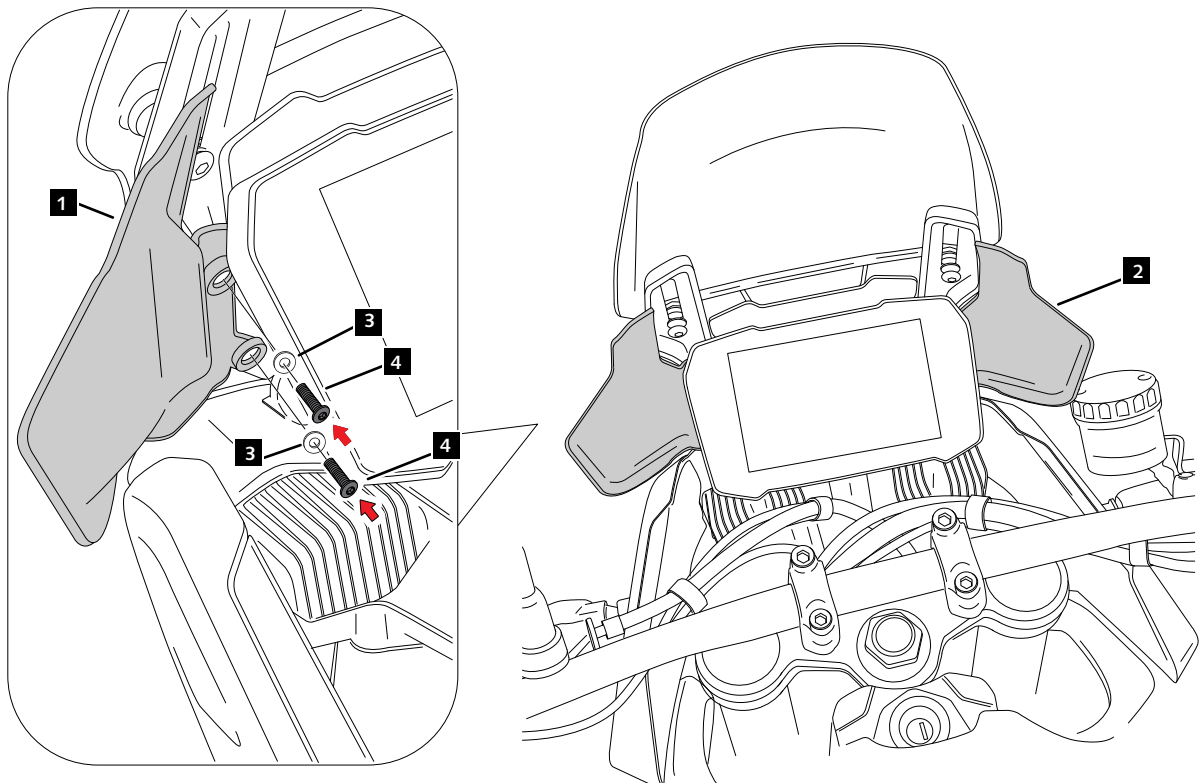

TRIUMPH
TIGER 900 /GT /GT PRO/ GT LOW '20- / TIGER 850 SPORT '21-

INSTRUCCIONES DE MONTAJE - MOUNTING INSTRUCTIONS - MONTAGEANLEITUNG

1

DISASSEMBLY
DESMONTAJE

**ASSEMBLY FOR
TIGER 900 GT/GT PRO/ GT LOW '24-**

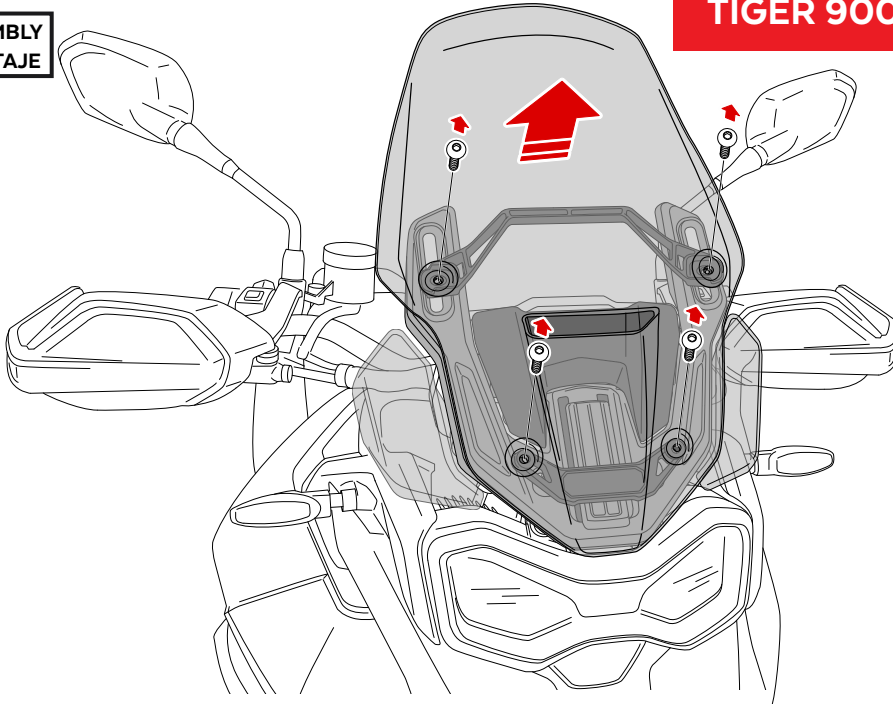

2

DISASSEMBLY
DESMONTAJE

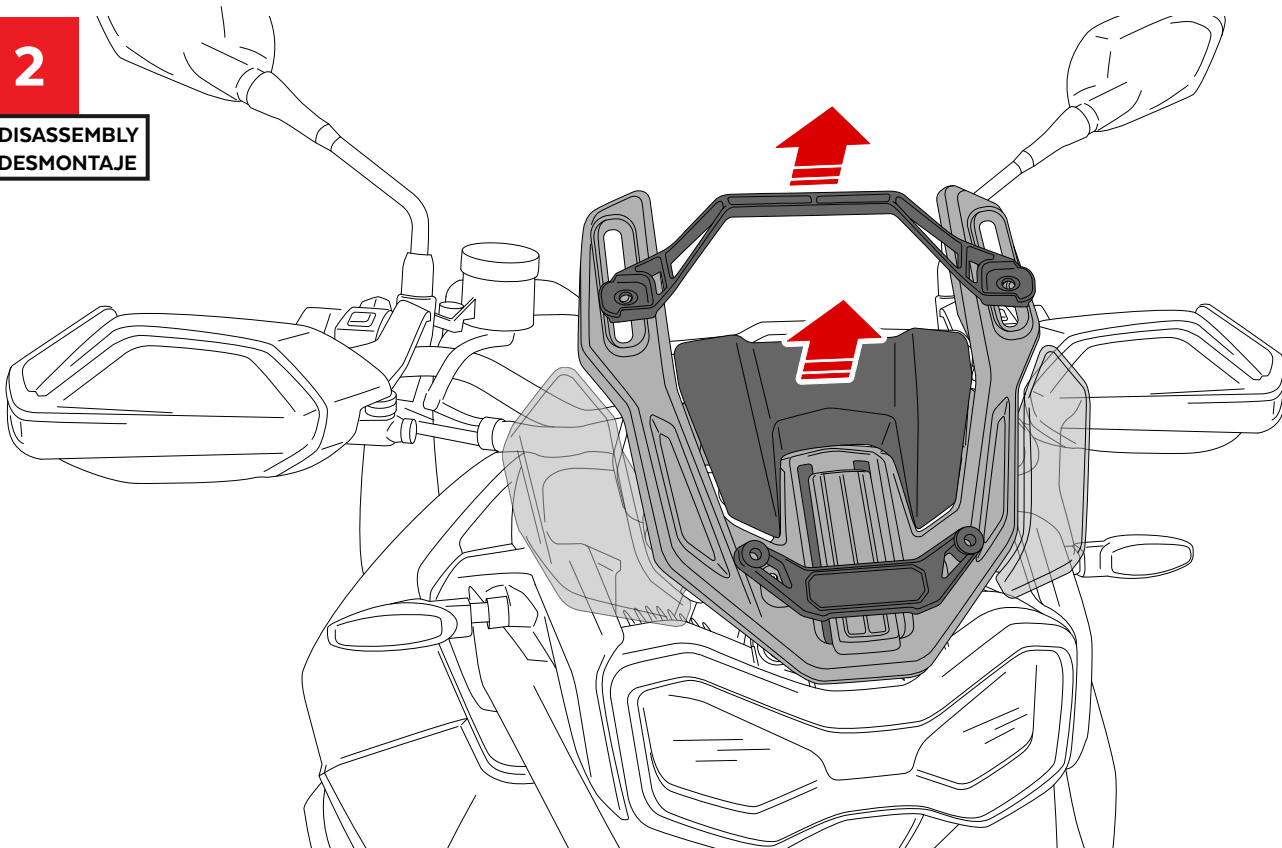

TRIUMPH
TIGER 900 /GT /GT PRO/ GT LOW '20-/ TIGER 850 SPORT '21-

INSTRUCCIONES DE MONTAJE - MOUNTING INSTRUCTIONS - MONTAGEANLEITUNG

3

DISASSEMBLY
DESMONTAJE

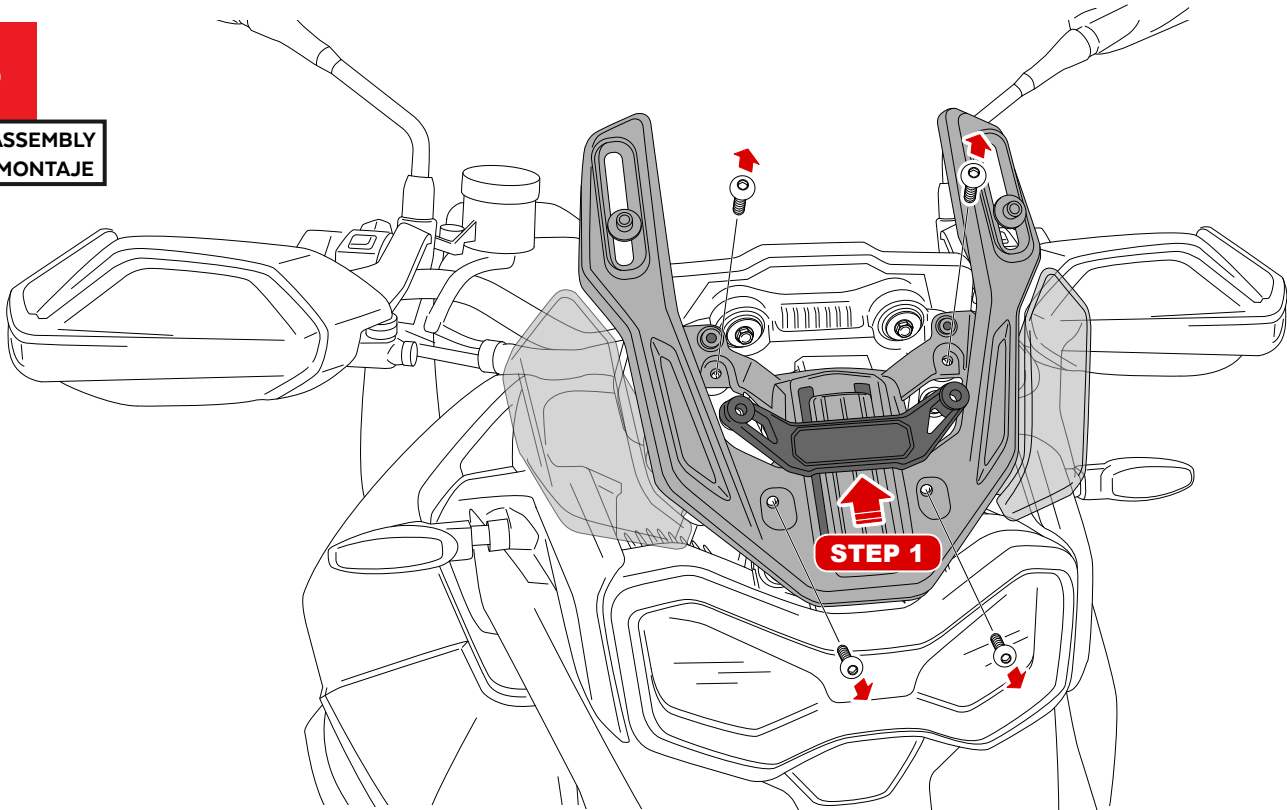

4

DISASSEMBLY
DESMONTAJE

180°

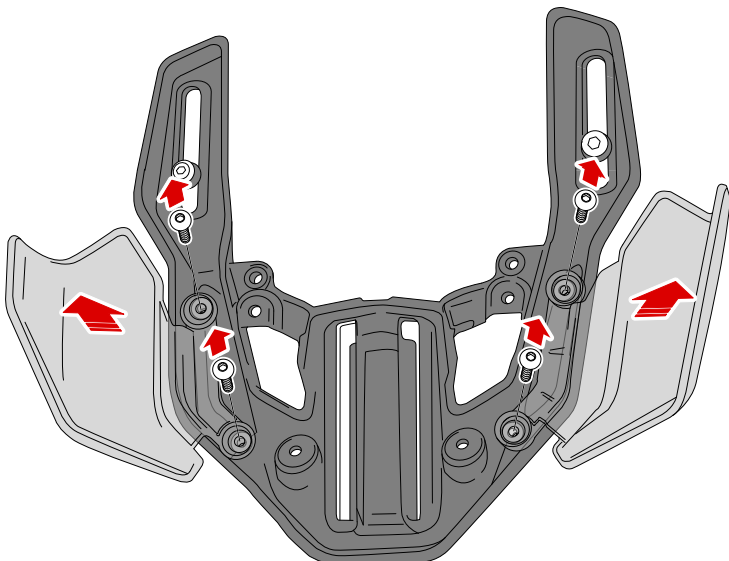

5

ASSEMBLY
MONTAJE

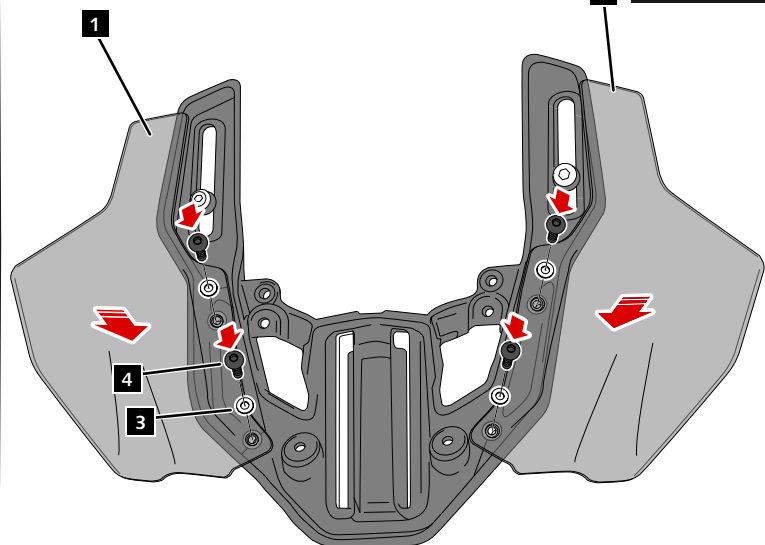

TRIUMPH
TIGER 900 /GT /GT PRO/ GT LOW '20-/ TIGER 850 SPORT '21-

INSTRUCCIONES DE MONTAJE - MOUNTING INSTRUCTIONS - MONTAGEANLEITUNG

6

ASSEMBLY
MONTAJE

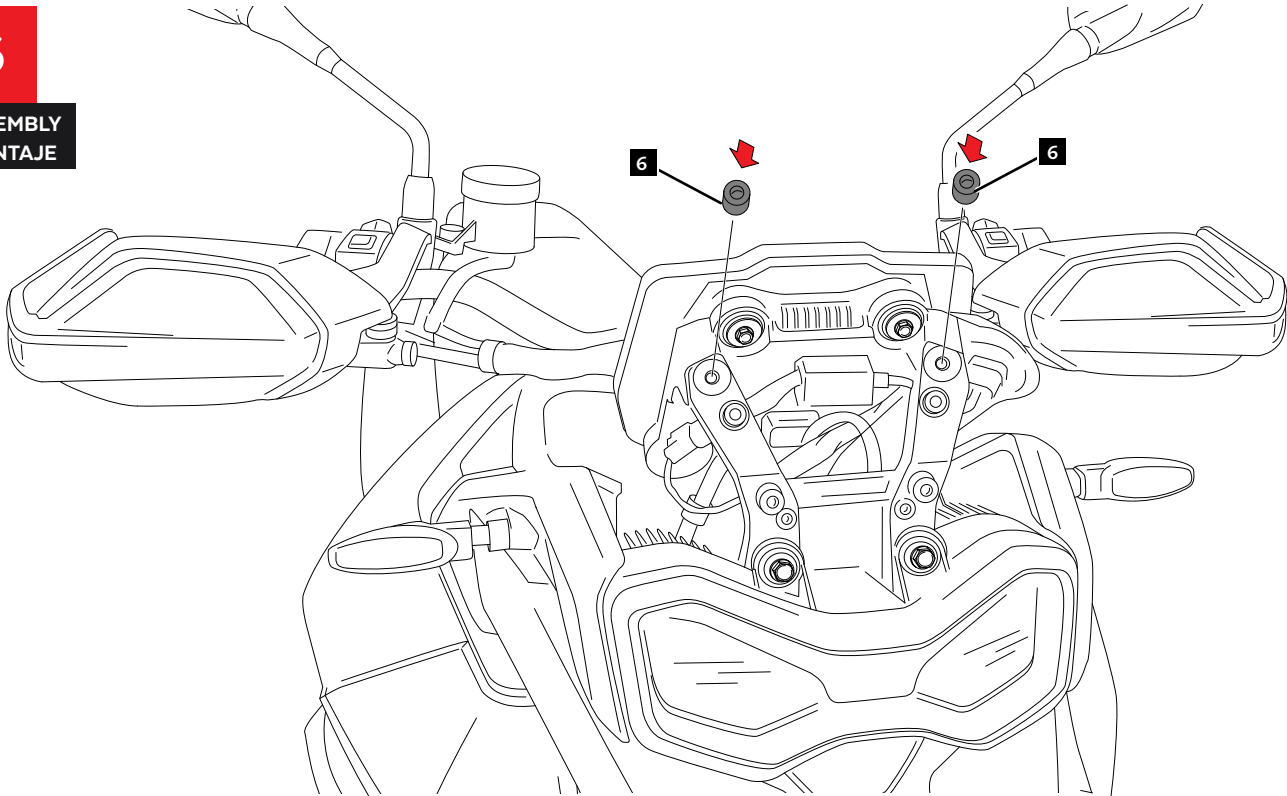

7

ASSEMBLY
MONTAJE

A Tornillería original
Original screws

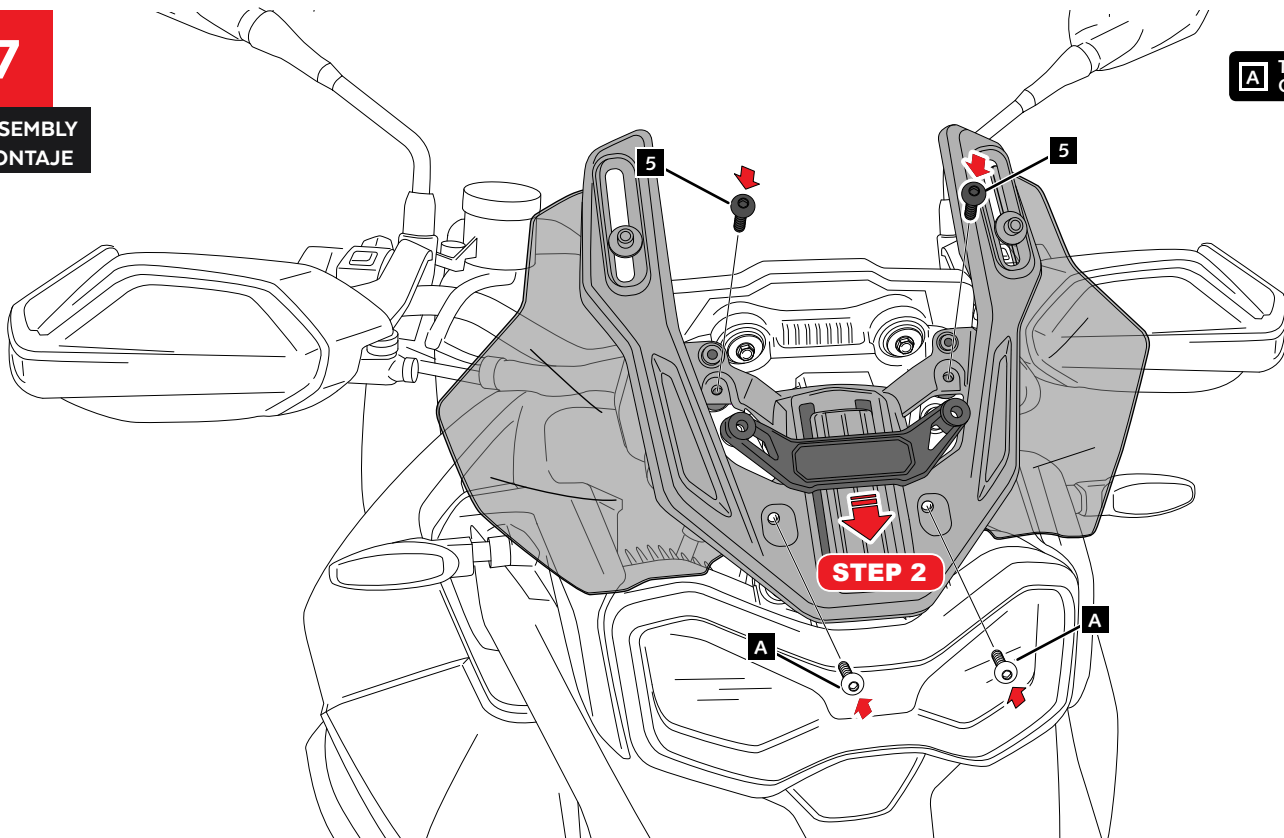

TRIUMPH
TIGER 900 /GT /GT PRO/ GT LOW '20-/ TIGER 850 SPORT '21-

INSTRUCCIONES DE MONTAJE - MOUNTING INSTRUCTIONS - MONTAGEANLEITUNG

8

ASSEMBLY
MONTAJE

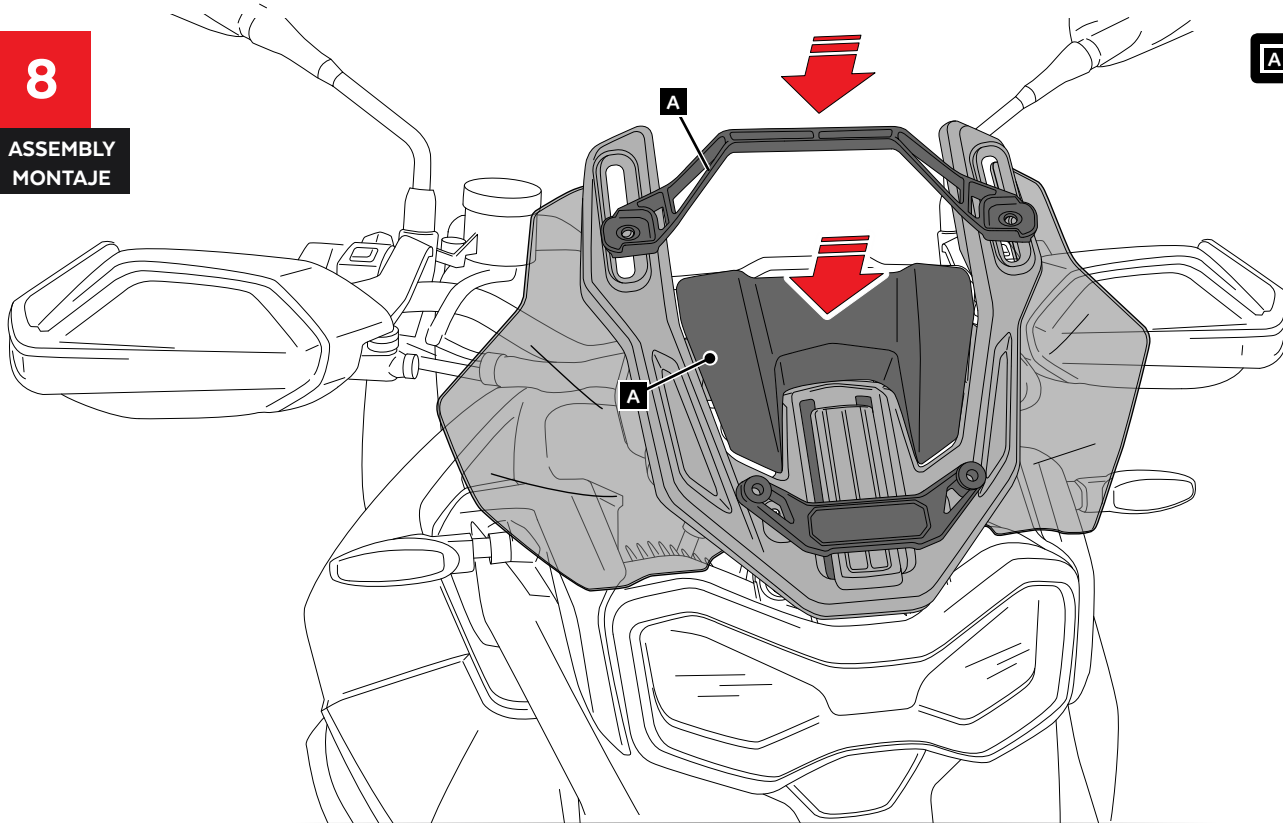

9

ASSEMBLY
MONTAJE

