

BMW R1300GS '24-

M O U N T I N G I N S T R U C T I O N S

REF 22305

REAR SEAT COWL



1 Person



15 min



EASY



TORX
T25



ALLEN
N° 3

ID	PIEZA/PART	DESCRIPCIÓN	DESCRIPTION	QTY	REF
1		Colín	Rear seat cowl	1	22305JM3
2		Soporte	Support	1	SOPORIP3--22305
3		Espuma	Foam	1	ESPUMA----22305
4		Tornillo Allen M6x40 ISO7380	M6x40 ISO7380 Allen screw	4	TORNI-I7380-538
5		Arandela M6 DIN9021	M6 DIN9021 washer	8	ARAND-PI-M6-400
6		Tornillo Allen M5x10 DIN7991	M5x10 DIN7991 Allen screw	4	TORNI-D7991-808
7		Arandela de goma Ø4,5 x Ø11 x 2mm	Ø4,5 x Ø11 x 2mm rubber washer	4	ARAND-EPDM--722
8		Tapón tornillo M5 DIN7991	M5 DIN7991 screw cap	4	TAPON-----92

BMW R1300GS '24-

INSTRUCCIONES DE MONTAJE - MOUNTING INSTRUCTIONS - MONTAGEANLEITUNG

1

DISASSEMBLY
DESMONTAJE

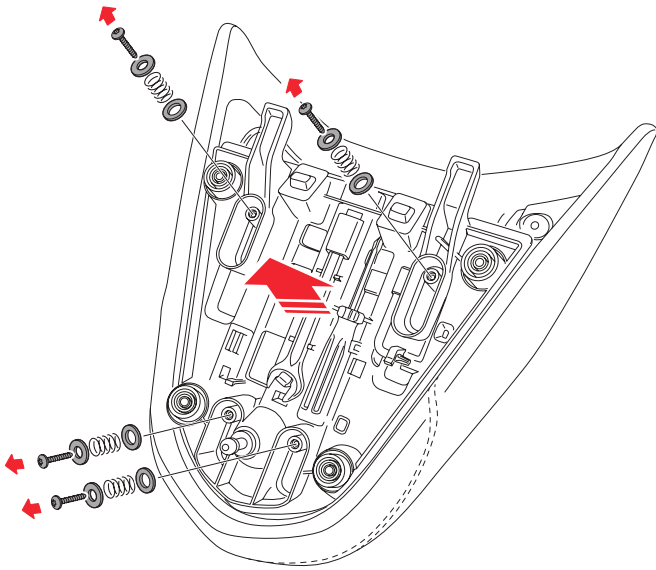

2

ASSEMBLY
MONTAJE

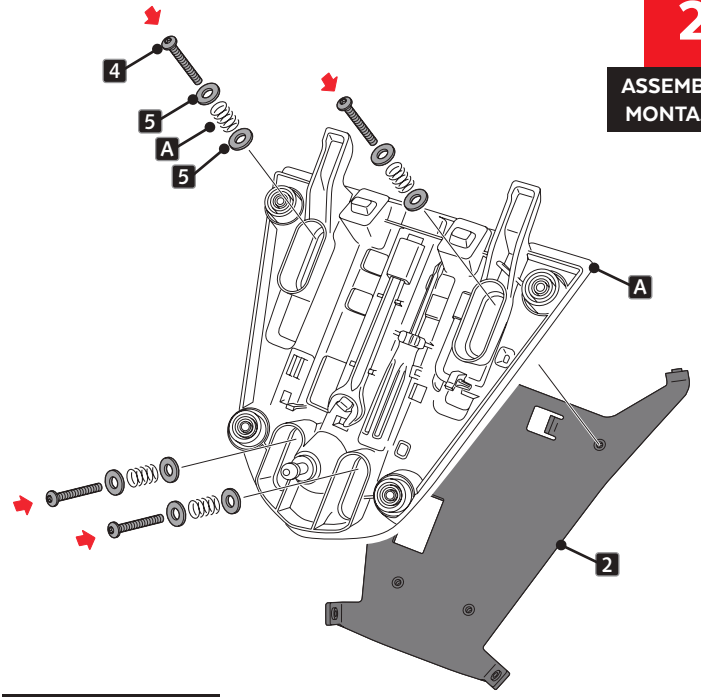

A PIEZA ORIGINAL
ORIGINAL PART

3

ASSEMBLY
MONTAJE

