

# KTM 990 DUKE '24-

## M O U N T I N G I N S T R U C T I O N S

REF 22178

DOWNFORCE NAKED FRONTAL SPOILERS



ID	PIEZA/PART	DESCRIPCIÓN	DESCRIPTION	QTY	REF
1		Alerón derecho (ABS)	Right spoiler (ABS)	1	11032JM3
2		Alerón izquierdo (ABS)	Left spoiler (ABS)	1	11032JM3
3		Deflector derecho	Right deflector	1	11034TM3
4		Deflector izquierdo	Left deflector	1	11034TM3
5		Soporte derecho	Right support	1	SOPOR2P3-R22178
6		Soporte izquierdo	Left support	1	SOPOR2P3-L22178
7		Tornillo Allen M8x45 ISO 7380	M8x45 ISO 7380 Allen screw	2	TORNI-I7380-817
8		Casquillo Ø8,5 x Ø13 x 15mm	Ø8,5 x Ø13 x 15mm Arrowhead	2	CASQUI-M----614
9		Tornillo Allen M5x16 Ø11 ISO 7380	M5x16 Ø11 ISO 7380 Allen screw	2	TORNI-I7380-493
10		Casquillo Ø8,5 x Ø13 x 3,5mm	Ø8,5 x Ø13 x 3,5mm Arrowhead	2	CASQUI-----775
11		Tornillo especial M5x11 Long Hexagonal 15 ( rosca int M5x12)	Special screw M5x11 Hexagonal length 15 mm ( M5x12)	4	TORNI-EM5---781
12		Tuerca autoblocante M5 DIN982	M5 DIN982 Lock nut	4	TUERCA-D982-746
13		Arandela de goma Ø4,5x Ø11x 2 mm	Ø4,5x Ø11x 2 mm Rubber washer	8	ARAND-EPDM--722
14		Arandela de nylon M5	M5 Nylon washer	8	ARNV00000000245
15		Tornillo Allen M5x12 Ø11 ISO 7380	M5x12 Ø11 ISO 7380 Allen screw	8	TORNI-AI----520
16		Tapón tornillo M5 ISO 7380	M5 ISO 7380 screw cap	10	TAPON-----85
17		Cinta auto-adhesiva de doble cara 3M, tamaño pequeño espesor 1,5mm	3M double-sided self-adhesive tape, small size, thickness 1.5mm	2	ADHESI3M--94X23
18		Kit adhesivos	Stickers set	1	ADHESI----21909

# KTM 990 DUKE '24-

## INSTRUCCIONES DE MONTAJE - MOUNTING INSTRUCTIONS - MONTAGEANLEITUNG

1

ASSEMBLY  
MONTAJE

Se muestra el montaje del lado derecho a modo de ejemplo, realizar los mismos pasos para el montaje del lado izquierdo  
The right side assembly is shown as an example, so the same steps can be performed for the left side assembly.

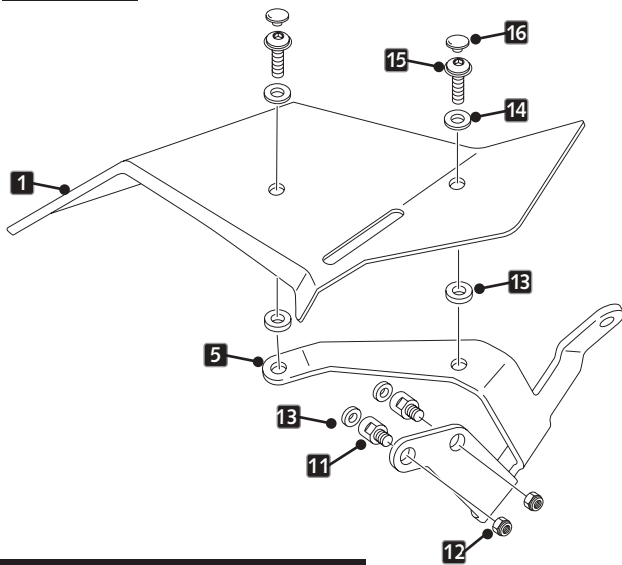

**15**  Par de apriete - 3 Nm  
Tightening torque - 3 Nm

2

ASSEMBLY  
MONTAJE

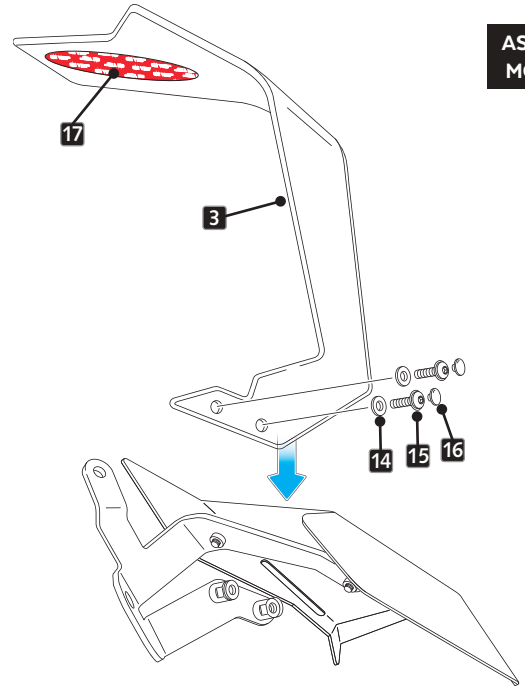

3

ASSEMBLY  
MONTAJE



**CLEAN THE SURFACE  
WITH NATURAL SOAP.**

**CHECK IS COMPLETELY DRY  
BEFORE START.**

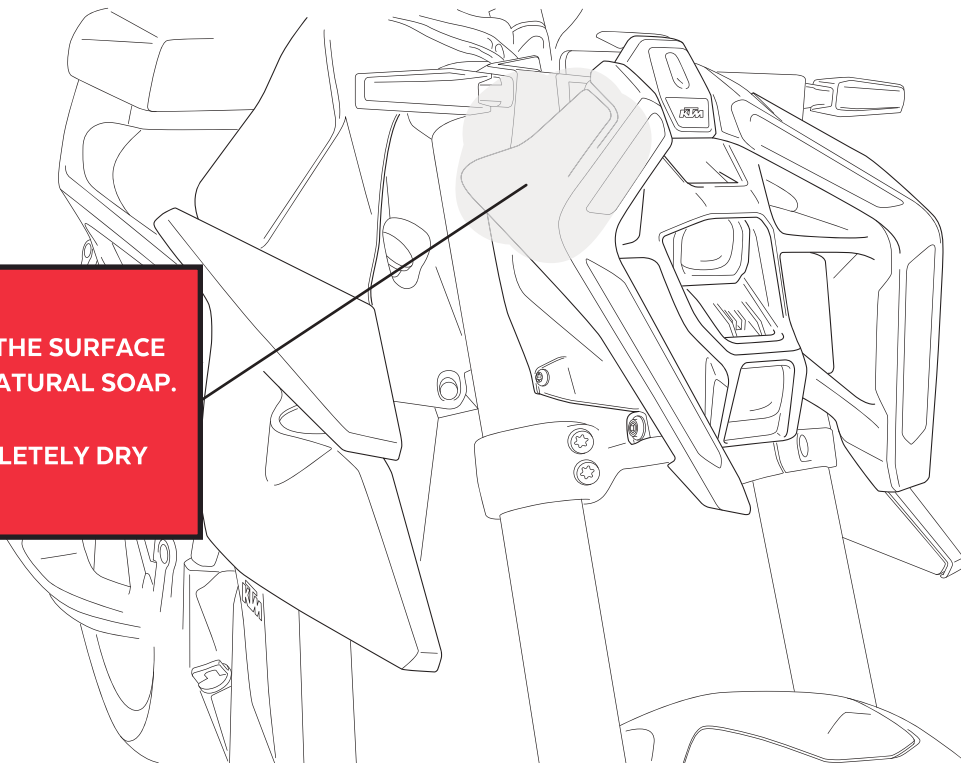

# KTM 990 DUKE '24-

INSTRUCCIONES DE MONTAJE - MOUNTING INSTRUCTIONS - MONTAGEANLEITUNG

**3**

DISASSEMBLY  
DESMONTAJE

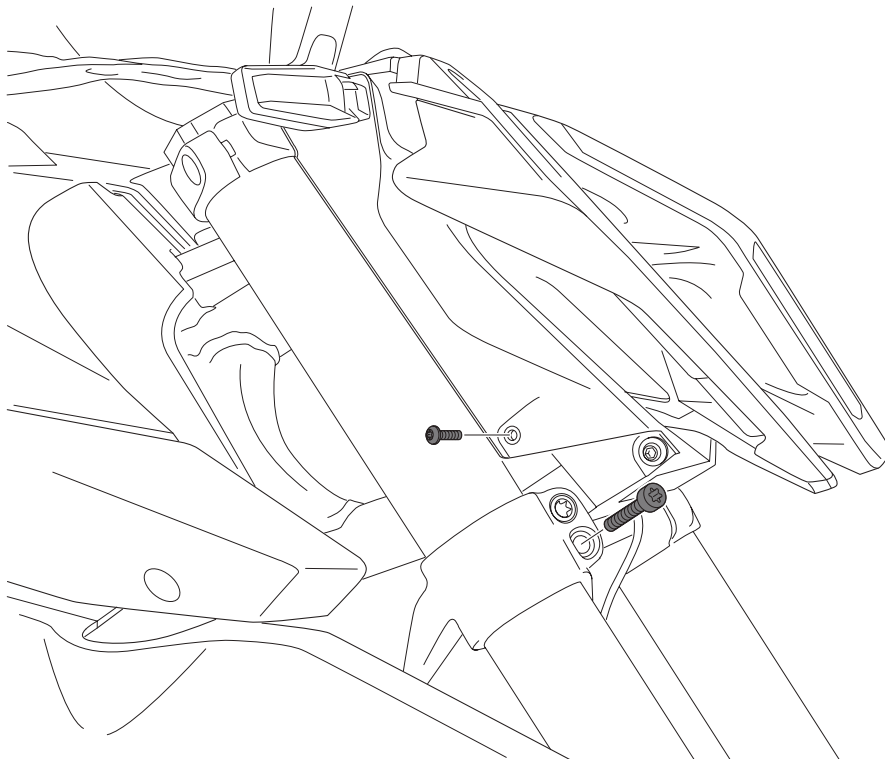

**4**

ASSEMBLY  
MONTAJE

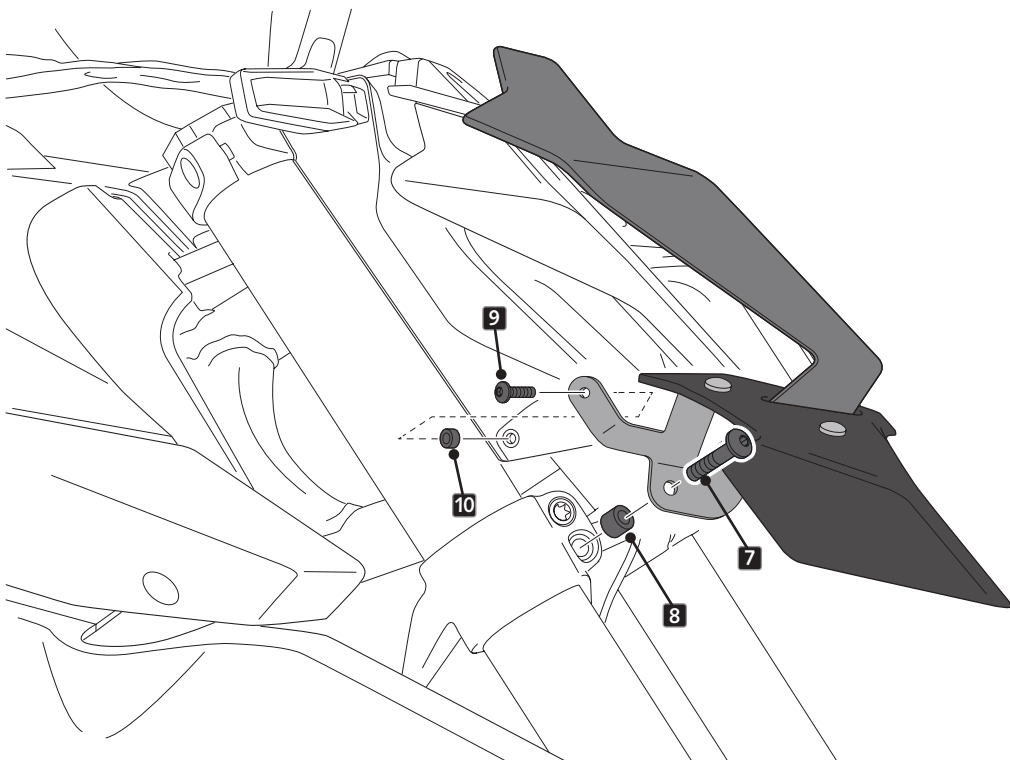

# KTM 990 DUKE '24-

## INSTRUCCIONES DE MONTAJE - MOUNTING INSTRUCTIONS - MONTAGEANLEITUNG

**6**

**ASSEMBLY  
MONTAJE**

### STEP 1

ASEGURAR LA CORRECTA POSICIÓN DEL CONJUNTO, SI ES NECESARIO, AJUSTAR LA POSICIÓN MEDIANTE TORNILLOS ID.11 Y ID.15.

ENSURE THE CORRECT POSITION OF THE ASSEMBLY, IF NECESSARY, ADJUST THE POSITION USING ID.11 AND ID.15 SCREWS

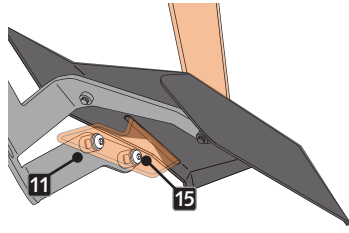

### STEP 2

EXTRAER EL PAPEL DEL ADHESIVO 3M  
REMOVE PAPER FROM 3M ADHESIVE

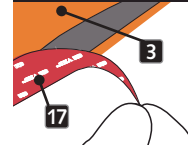

### STEP 3

APLICAR PRESION EN EL ÁREA DEL ADHESIVO DURANT 1 MINUTO

APPLY PRESSURE ON ADHESIVE AREA FOR 1 MINUTE

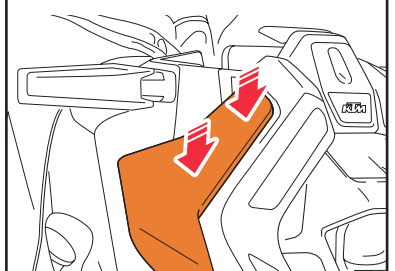

# KTM 990 DUKE '24-

INSTRUCCIONES DE MONTAJE - MOUNTING INSTRUCTIONS - MONTAGEANLEITUNG

**7**

ASSEMBLY  
MONTAJE

WAIT 24 HOURS



CHECK THE CORRECT ADHESION  
OF THE 3M DOUBLE SIDE  
SELF-ADHESIVE TAPE  
TO THE FAIRING. ENSURE THAT  
THE ENTIRE SURFACE  
IS WELL ADHERED

**8**

ASSEMBLY  
MONTAJE

## TIGHTEN SCREWS

**15**  Par de apriete - 3 Nm  
Tightening torque - 3 Nm

**11**  Par de apriete - 4 Nm  
Tightening torque - 4 Nm

**7**  Par de apriete - 12 Nm  
Tightening torque - 12 Nm

