

# HONDA CL500 '23-

## M O U N T I N G I N S T R U C T I O N S

REF 21634

**WINDSHIELD NG SPORT**



ALLEN

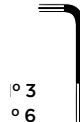

| ID. | PIEZA/PART | DESCRIPCIÓN                       | DESCRIPTION                    | QTY. | REF.:           |
|-----|------------|-----------------------------------|--------------------------------|------|-----------------|
| 1   |            | Cúpula Sport                      | Sport screen                   | 1    | 21634H/W/F/NM3  |
| 2   |            | Soporte Izquierdo (L)             | Left support (L)               | 1    | SOPOR2P3-L21634 |
| 3   |            | Soporte derecho (R)               | Right support (R)              | 1    | SOPOR2P3-R21634 |
| 4   |            | Casquillo Ø8 xØ14 x18             | Ø8 xØ14 x18 Arrowhead          | 2    | CASQUI-----0139 |
| 5   |            | Tornillo allen M8x50 DIN912       | M8x50 DIN912 Screw             | 2    | TORNI-D912--532 |
| 6   |            | Silentblock Ø12xØ6x9              | Ø12xØ6x9 Silentblock           | 2    | AROPASACABLES-1 |
| 7   |            | Silentblock M5                    | M5 silentblock                 | 4    | SILENBTM5-046/1 |
| 8   |            | Arandela de nylon M5              | M5 Nylon washer                | 4    | ARNV00000000245 |
| 9   |            | Tornillo allen M5x16 Ø11 ISO 7380 | M5x16 Ø11 ISO 7380 allen screw | 4    | TORNI-I7380-493 |
| 10  |            | Tapón tornillo M5 ISO 7380        | M5 ISO 7380 screw cap          | 4    | TAPON-----85    |

# HONDA CL500 '23-

INSTRUCCIONES DE MONTAJE - MOUNTING INSTRUCTIONS - MONTAGEANLEITUNG

**1**

**DISASSEMBLY  
DESMONTAJE**

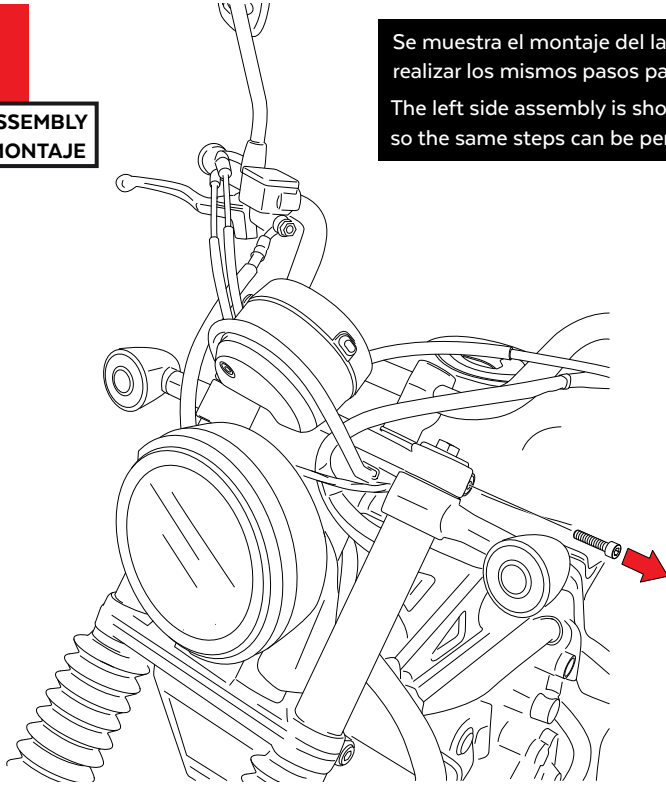

Se muestra el montaje del lado izquierdo a modo de ejemplo, realizar los mismos pasos para el montaje del lado derecho.  
The left side assembly is shown as an example, so the same steps can be performed for the right side assembly.

**2**

**ASSEMBLY  
MONTAJE**

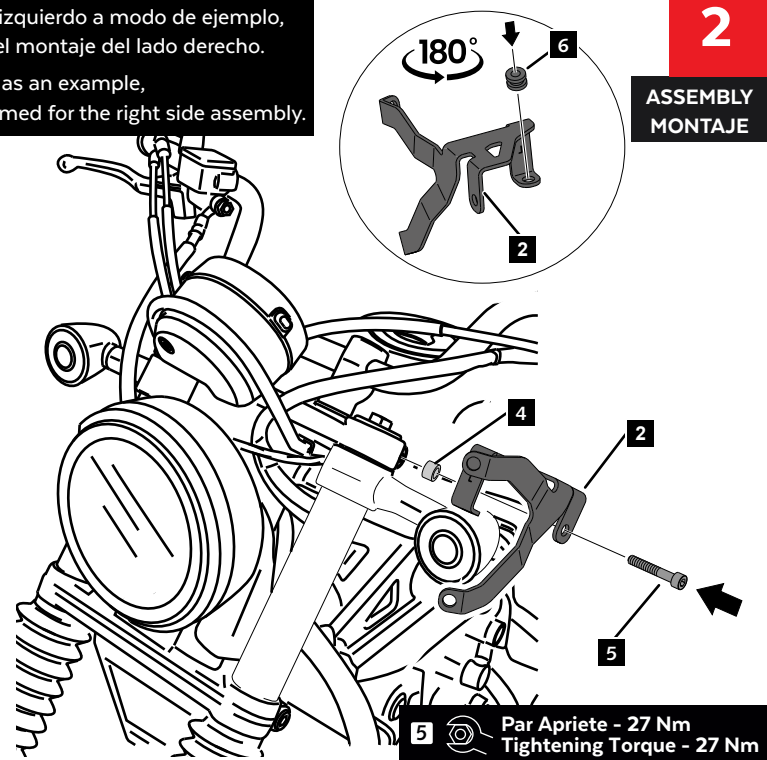

**3**

**ASSEMBLY  
MONTAJE**

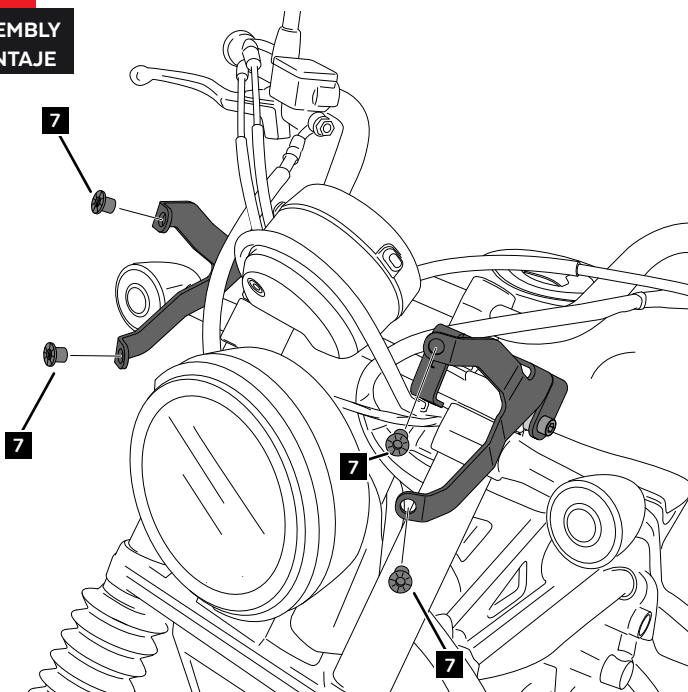

**4**

**ASSEMBLY  
MONTAJE**

