

BMW S1000RR '19-

M O U N T I N G I N S T R U C T I O N S

VIDEO

REF 20522

FRONTAL GP SPOILER / ALERON FRONTAL GP



1 Person



20 min



EASY



TORX
T25

ALLEN
Nº 3



ID	PIEZA/PART	DESCRIPCIÓN	DESCRIPTION	QTY	REF
1		Soporte aluminio derecho	Right aluminium support	1	SOPOR2P5-R20522
2		Soporte aluminio izquierdo	Left aluminium support	1	SOPOR2P5-L20522
3		Pieza soporte alerón (Tamaño pequeño)	Spoiler support piece (small size)	4	SOPOR-I---20431
4		Alerón derecho	Right spoiler	1	10907N/F/HM3
5		Alerón izquierdo	Left spoiler	1	10907N/F/HM3
6		Tornillo Allen M5x30 Ø11 ISO 7380	M5x30 Ø11 ISO 7380 Allen screw	2	TORNI-I7380-767
7		Casquillo Ø13 x Ø8,5 x 9mm	Ø13 x Ø8,5 x 9mm arrowhead	2	CASQUI-----777
8		Tornillo Allen M5x20 Ø11 ISO 7380	M5x20 Ø11 ISO 7380 Allen screw	2	TORNI-I7380-730
9		Tapón tornillo M5 DIN7991 (NEGRO)	M5 DIN7991 Screw cap (Black)	2	TAPON-----92
10		Tornillo M5x16 DIN7991 (NEGRO)	M5x16 DIN7991 Allen screw (black)	2	TORNI-D7991-867
11		Arandela de goma Ø4,5 x Ø11 x 2mm	Ø4,5 x Ø11 x 2mm Rubber washer	2	ARAND-EPDM--722
12		KIT Adhesivos	Stickers set	1	ADHESI----20522
13		Plantilla	Template	1	PLANT-----20522
14		Lápiz AP111 Adhesion promoter	AP111 adhesion promoter Pen	1	KITNETEJA-----

* Algunos de los Componentes se suministran montados / Some components are supplied assembled

BMW S1000RR '19-

INSTRUCCIONES DE MONTAJE - MOUNTING INSTRUCTIONS - MONTAGEANLEITUNG

1

DISASSEMBLY
DESMONTAJE

Se muestra el montaje del lado derecho a modo de ejemplo, realizar los mismos pasos para el montaje del lado izquierdo.
The right side assembly is shown as an example, so the same steps can be performed for the left side assembly.

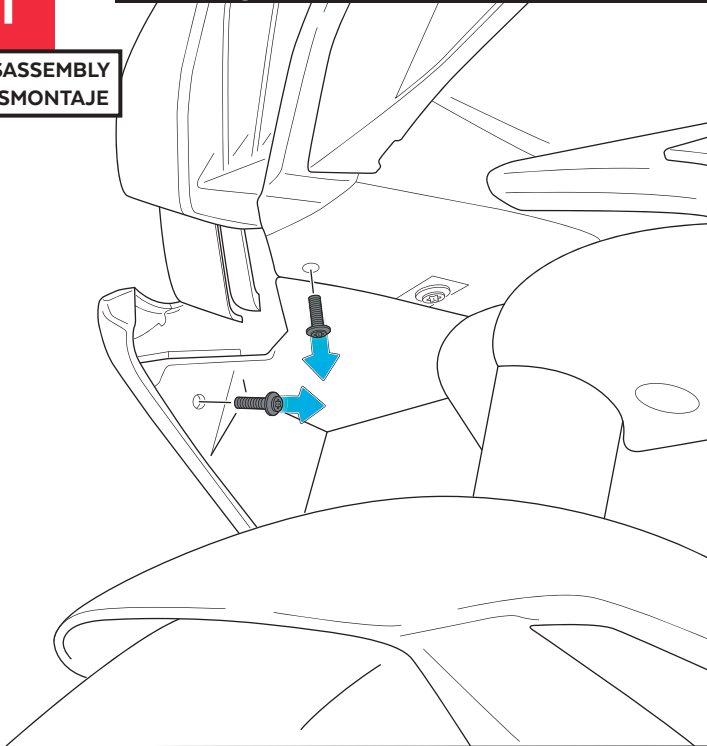

2

ASSEMBLY
MONTAJE

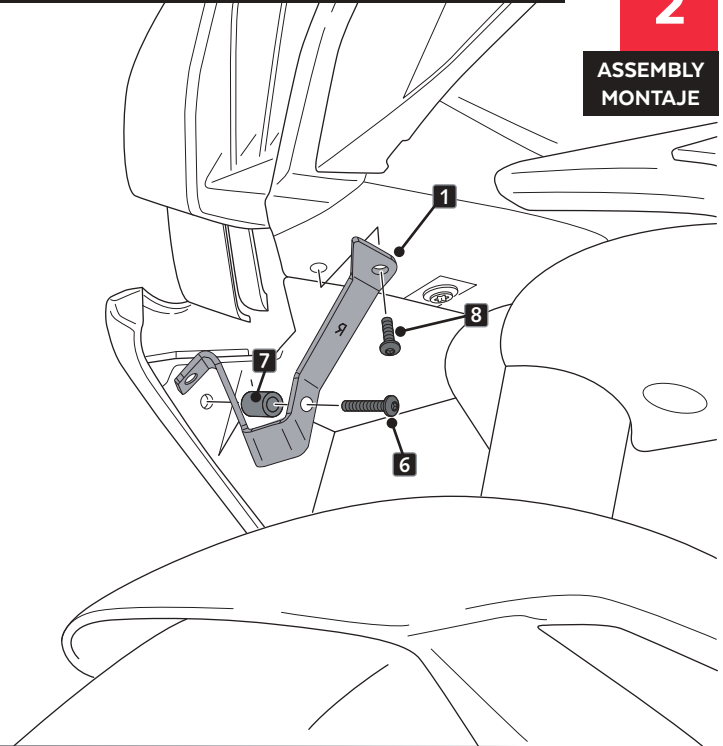

3

ASSEMBLY
MONTAJE

13 Use the same template for the left and right side

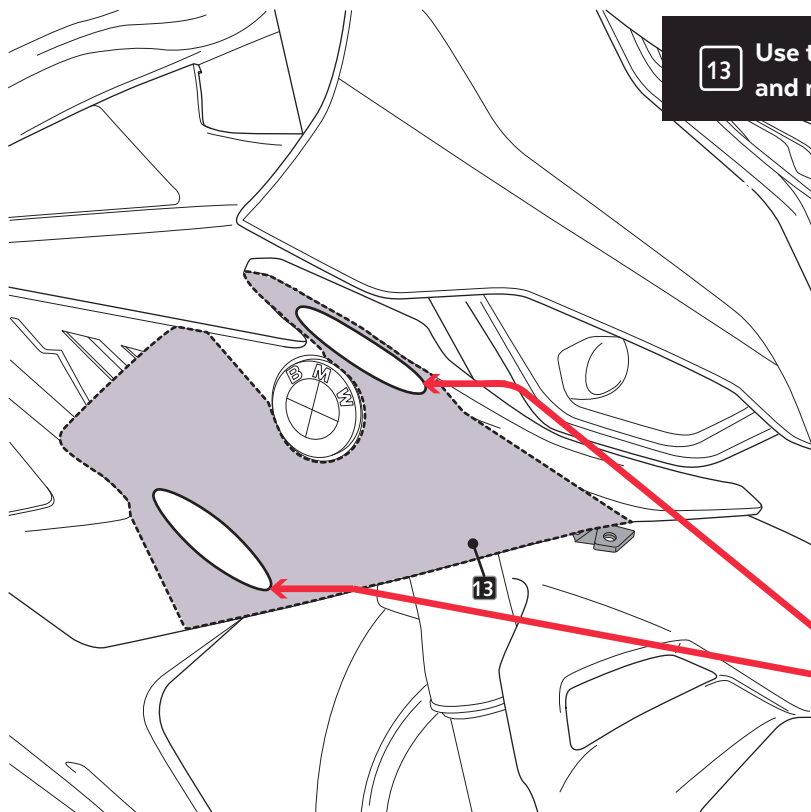

CLEAN THE SURFACE
WITH NATURAL SOAP.

14



PRESS HARD THE PEN ID14
UNTIL THE GLASS INSIDE
BREAKS AND
THE FLUID FLOWS



APPLY THE PEN
ONLY ON SPOILER
SUPPORT PIECE
AREA.

CHECK IS COMPLETELY DRY
BEFORE START.

BMW S1000RR '19-

INSTRUCCIONES DE MONTAJE - MOUNTING INSTRUCTIONS - MONTAGEANLEITUNG

4

ASSEMBLY
MONTAJE

4.1 DOBLAR LOS EXTREMOS DE LA PIEZA
FOLD THE ENDS OF THE PIECE

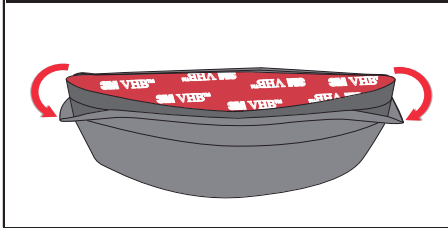

4.2 EXTRAER PAPEL DEL ADHESIVO 3M
REMOVE PAPER FROM 3M ADHESIVE

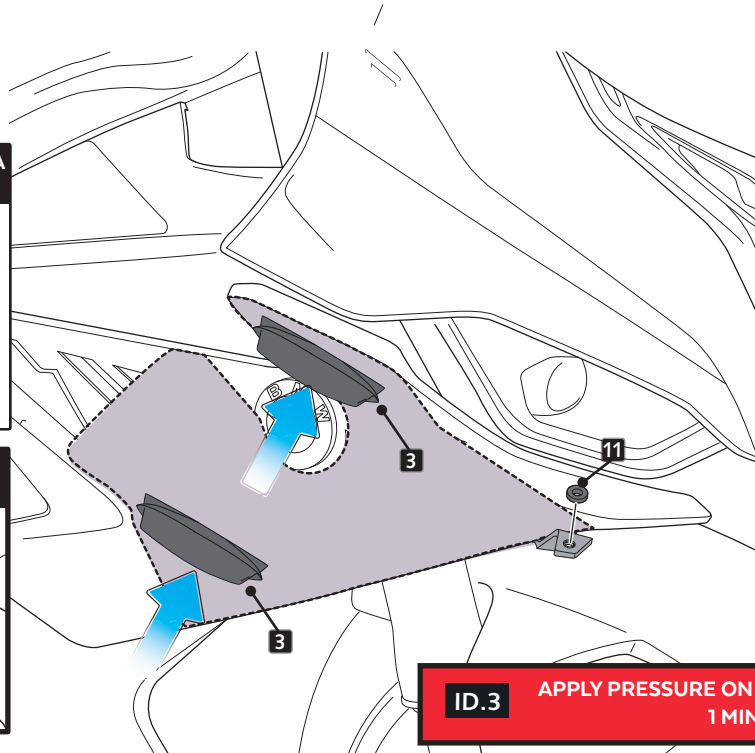
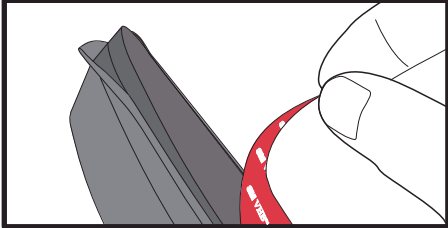

ID.3

APPLY PRESSURE ON ADHESIVE AREA FOR
1 MINUT

5

ASSEMBLY
MONTAJE

WAIT 24 HOURS



CHECK THE CORRECT ADHESION
OF THE 3M DOUBLE SIDE
SELF-ADHESIVE TAPE
TO THE FAIRING. ENSURE THAT
THE ENTIRE SURFACE
IS WELL ADHERED

BMW S1000RR '19-

INSTRUCCIONES DE MONTAJE - MOUNTING INSTRUCTIONS - MONTAGEANLEITUNG

6

ASSEMBLY
MONTAJE

ID13 EXTRAER PLANTILLA ANTES DE MONTAR EL ALERÓN.
REMOVE TEMPLATE BEFORE ASSEMBLY THE SPOILER

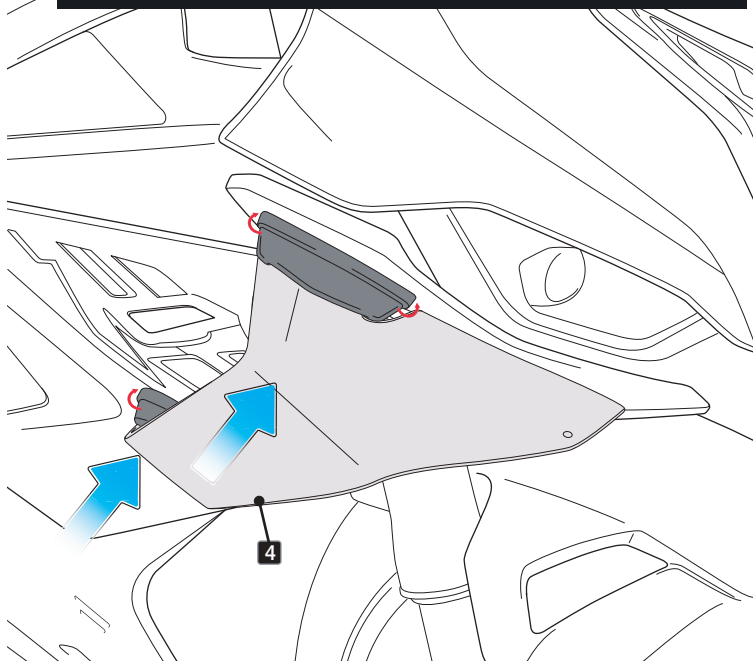

7

ASSEMBLY
MONTAJE

