

HONDA CBR1000RR FIREBLADE / SP '20-

M O U N T I N G I N S T R U C T I O N S

VIDEO

REF 20508

FRONTAL GP SPOILER / ALERON FRONTAL GP

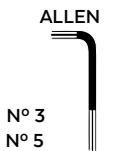

ID.	PIEZA/PART	DESCRIPCIÓN	DESCRIPTION	QTY.	REF.:
1		Base alerón (ABS)	Main spoiler (ABS)	1	20508JM3
2		SopORTE metálico	Metal support	1	SOPORIP2--20508
3		Pieza soporte alerón (Tamaño pequeño)	Spoiler support piece (small size)	2	SOPOR-I---20431
4		Deflector derecho	Right deflector	1	20508A/N/R/WM3
5		Deflector izquierdo	Left deflector	1	20508A/N/R/WM3
6		Kit velcro dual lock (tamaño pequeño)	Kit dual lock velcro (small size)	2	VELCRO---I20431
7		Tapon tornillo M5 ISO7380	M5 ISO7380 screw cap	8	TAPON-----85
8		Tornillo allen M5x30 Ø11 ISO 7380	M5x30 Ø11 ISO 7380 allen screw	4	TORNI-I7380-767
9		Casquillo Ø13xØ8,5x9mm	Ø13xØ8,5x9mm arrowhead	4	CASQUI-----777
10		Tornillo M5x16 Ø11 ISO7380 (negro)	M5x16 Ø11 ISO7380 screw (black)	4	TORNI-I7380-493
11		Tornillo M5x11 ISO7380 (Negro)	M5x11 ISO7380 screw (black)	4	TORNI-AI-----520
12		Tuerca autoblocante M5	M5 lock Nut	4	TUERCA-D982-745
13		Arandela de goma Ø4,5xØ11x2mm	Ø4,5xØ11x2mm rubber washer	8	ARAND-EPDM--722
14		Tope de goma Ø3,7-3,8x3,2mm	Ø3,7-3,8x3,2mm bumper foot	4	TOPE--POF-40022
15		Arandela de nylon M5	M5 nylon washer	12	ARNV0000000245
16		Plantilla	Template	1	PLANT-----20508

* Algunos componentes se suministran montados.
Some components are supplied assembled.

HONDA CBR1000RR FIREBLADE / SP '20-

INSTRUCCIONES DE MONTAJE - MOUNTING INSTRUCTIONS - MONTAGEANLEITUNG

1

**DISASSEMBLY
DESMONTAJE**

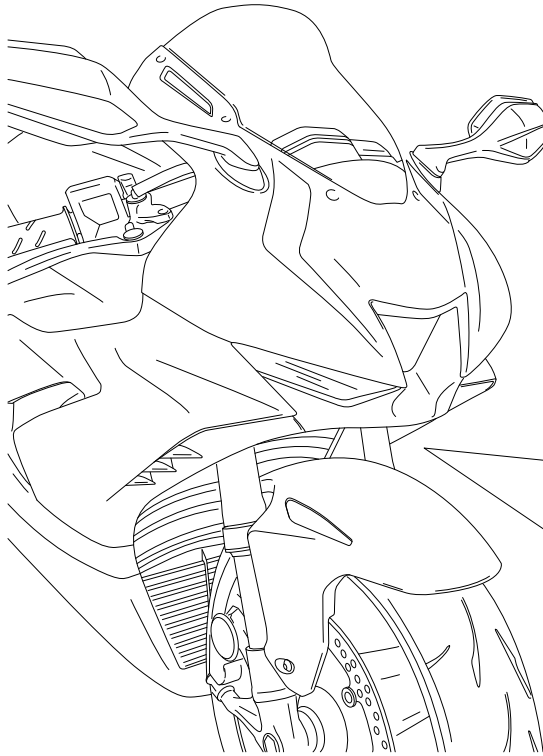

A Tornillo original
Original screw

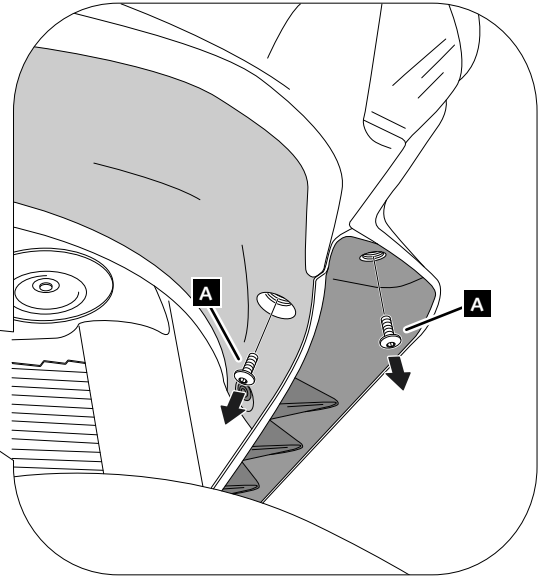

2

**ASSEMBLY
MONTAJE**

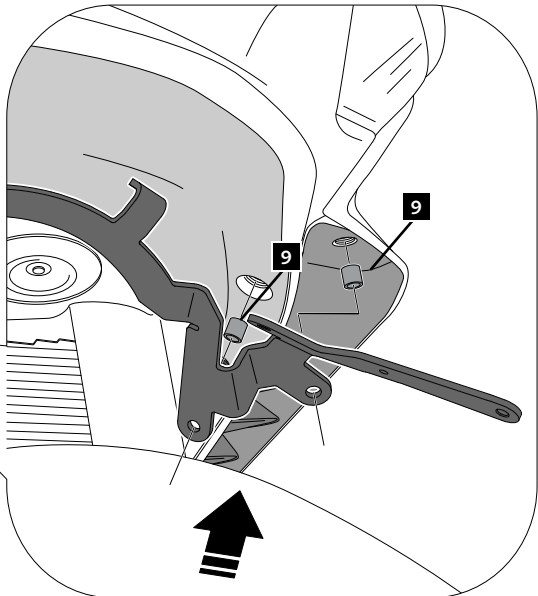
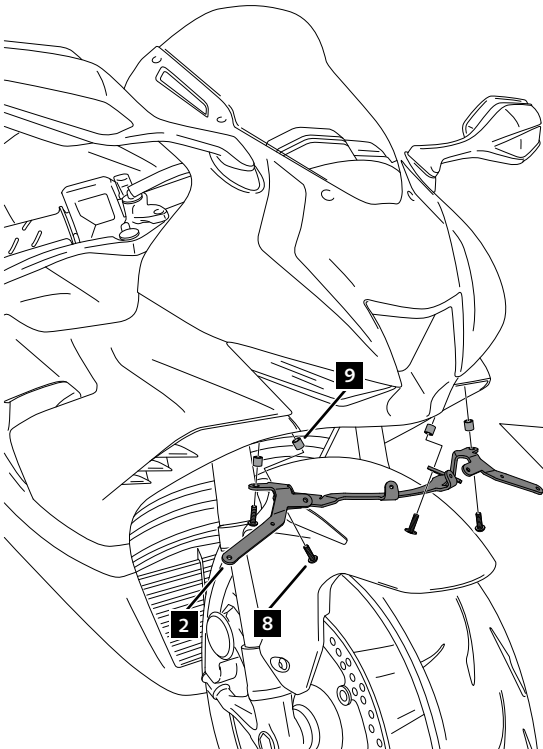

HONDA CBR1000RR FIREBLADE / SP '20-

INSTRUCCIONES DE MONTAJE - MOUNTING INSTRUCTIONS - MONTAGEANLEITUNG

3

ASSEMBLY
MONTAJE

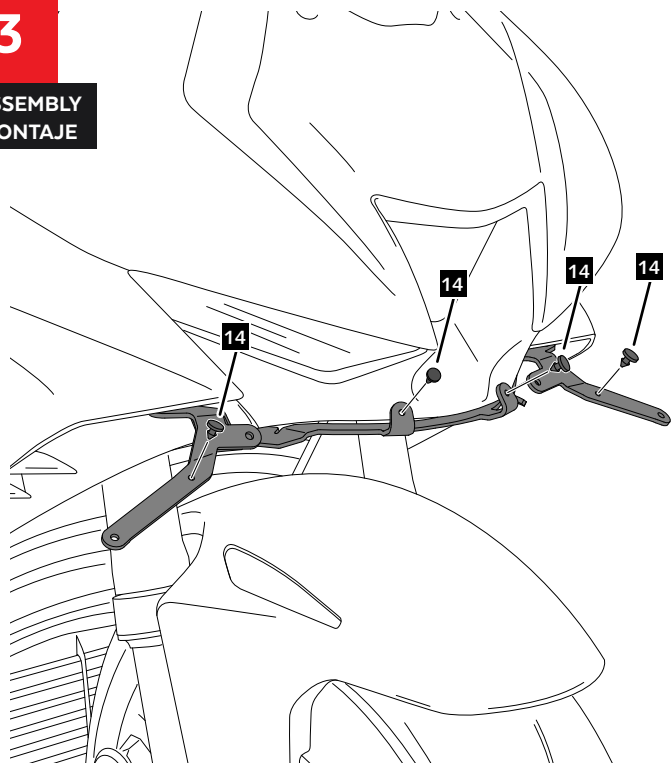

4

ASSEMBLY
MONTAJE

Se muestra el montaje del lado derecho a modo de ejemplo, realizar los mismos pasos para el montaje del lado izquierdo.
The right side assembly is shown as an example, so the same steps can be performed for the left side assembly.

ID16 Utilizar la misma plantilla para lado derecho e izquierdo
Use the same template for left or right side

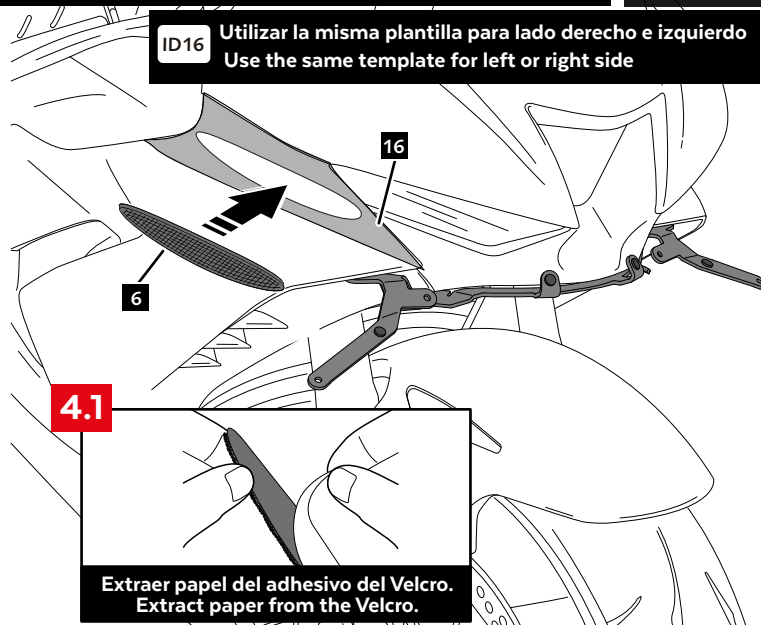

4.1

Extraer papel del adhesivo del Velcro.
Extract paper from the Velcro.

5

ASSEMBLY
MONTAJE

Se muestra el montaje del lado derecho a modo de ejemplo, realizar los mismos pasos para el montaje del lado izquierdo.
The right side assembly is shown as an example, so the same steps can be performed for the left side assembly.

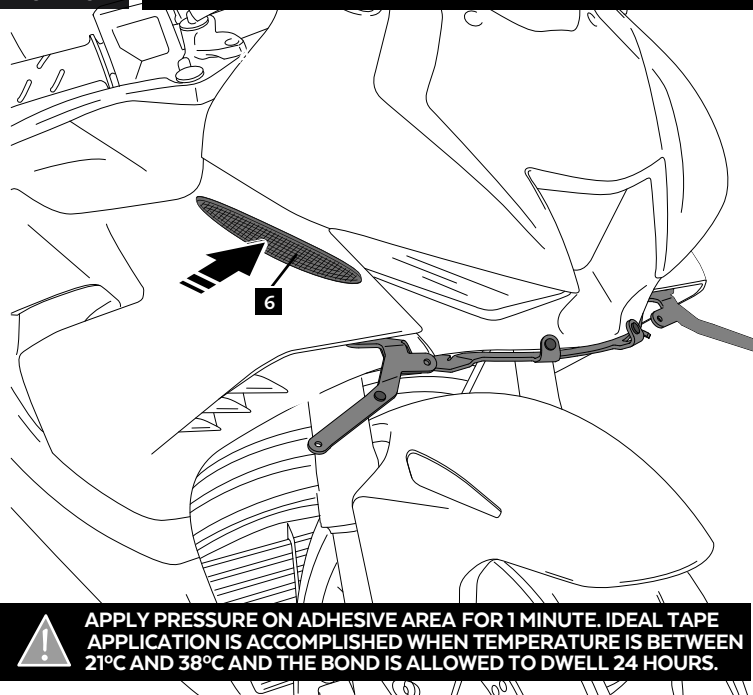

APPLY PRESSURE ON ADHESIVE AREA FOR 1 MINUTE. IDEAL TAPE APPLICATION IS ACCOMPLISHED WHEN TEMPERATURE IS BETWEEN 21°C AND 38°C AND THE BOND IS ALLOWED TO DWELL 24 HOURS.

6

ASSEMBLY
MONTAJE

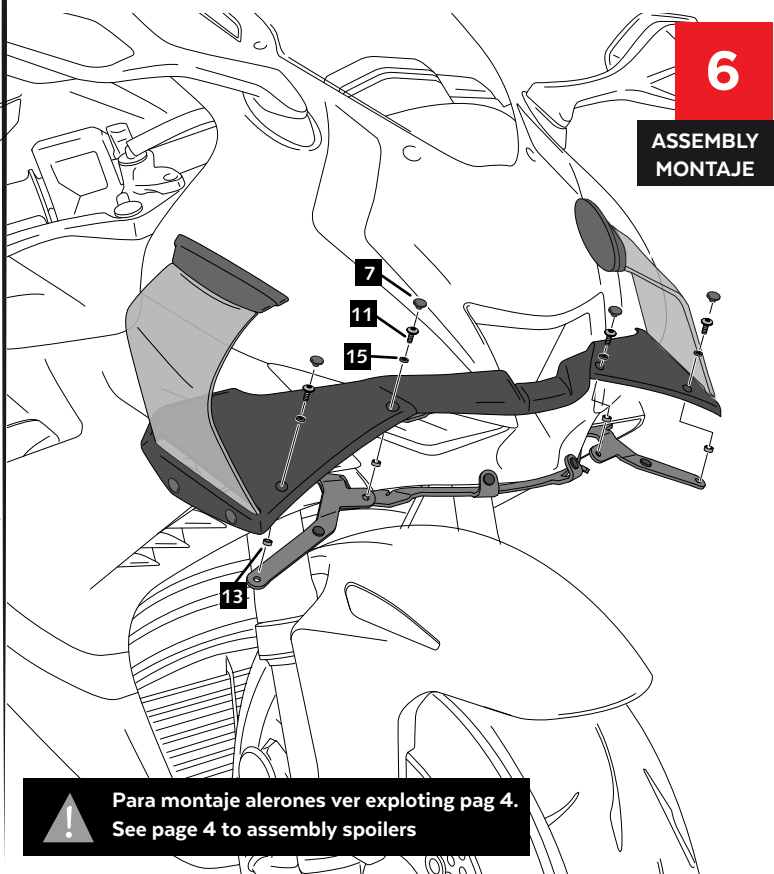

Para montaje alerones ver exploding pag 4.
See page 4 to assembly spoilers

HONDA CBR1000RR FIREBLADE / SP '20-

INSTRUCCIONES DE MONTAJE - MOUNTING INSTRUCTIONS - MONTAGEANLEITUNG

6

ASSEMBLY
MONTAJE

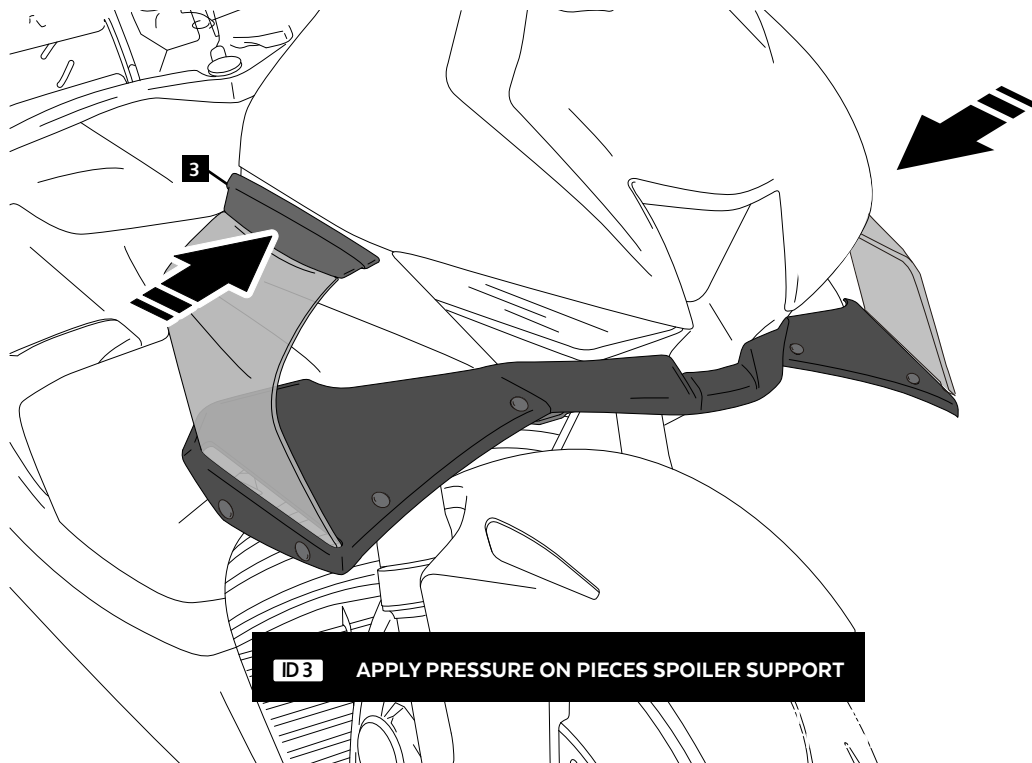

EXPLOTING
DESPIECE

